

Geometria Descritiva e Conceptual

20241308

RAFAEL SILVA



ÍNDICE

- **Exercício 1**
- **Exercício 2**
- **Apontamentos de aula – 1**
- **Exercício 3**
- **Exercício 4**
- **Exercício 5**
- **Exercício 6**
- **Exercício 7**
- **Apontamentos de aula – 2**
- **Exercício 8**
- **Exercício 9**
- **Exercício 10**
- **Exercício 11**
- **Exercício 12**
- **Exercício 13**
- **Exercício 14**

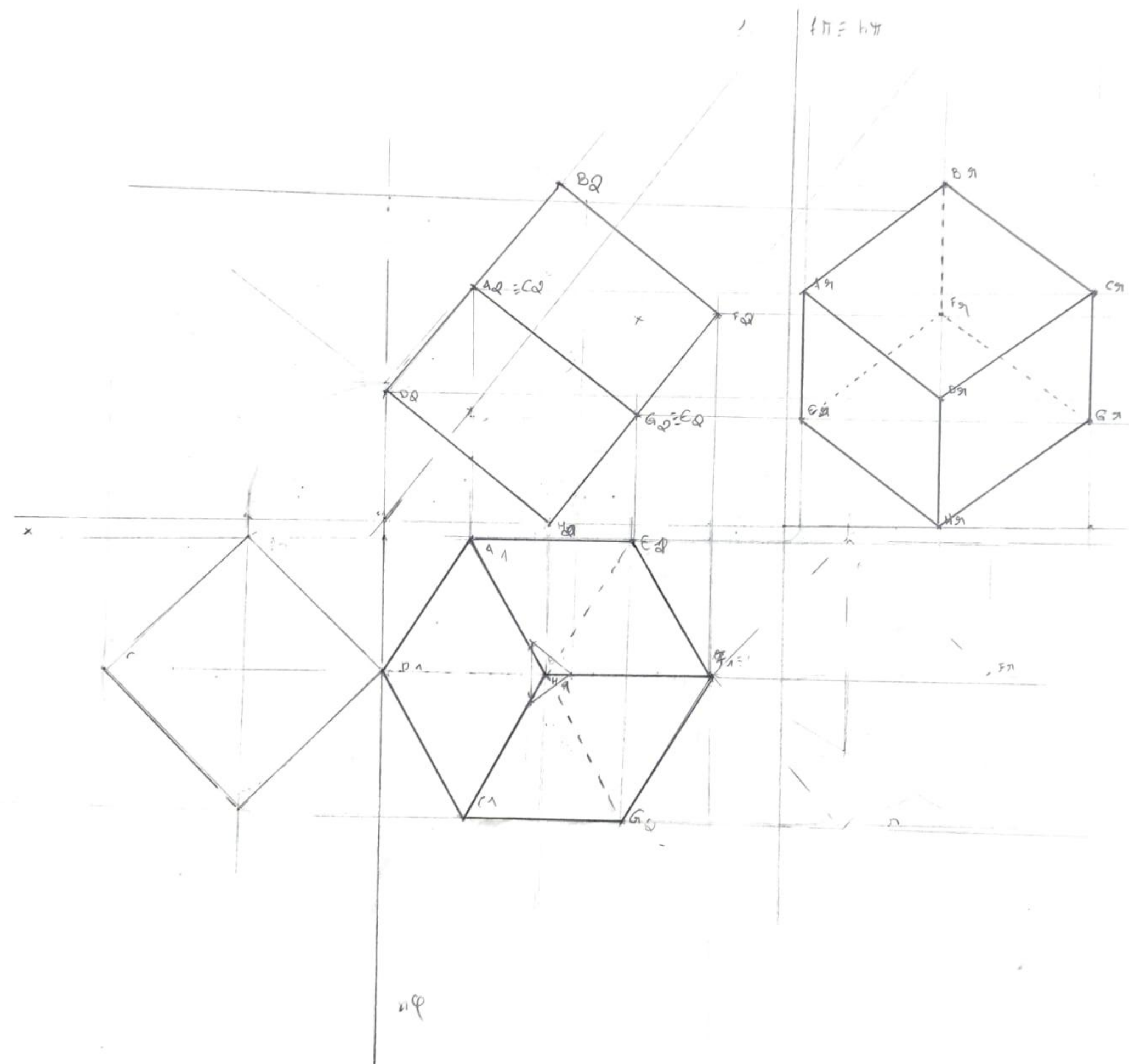

Exerc. 1

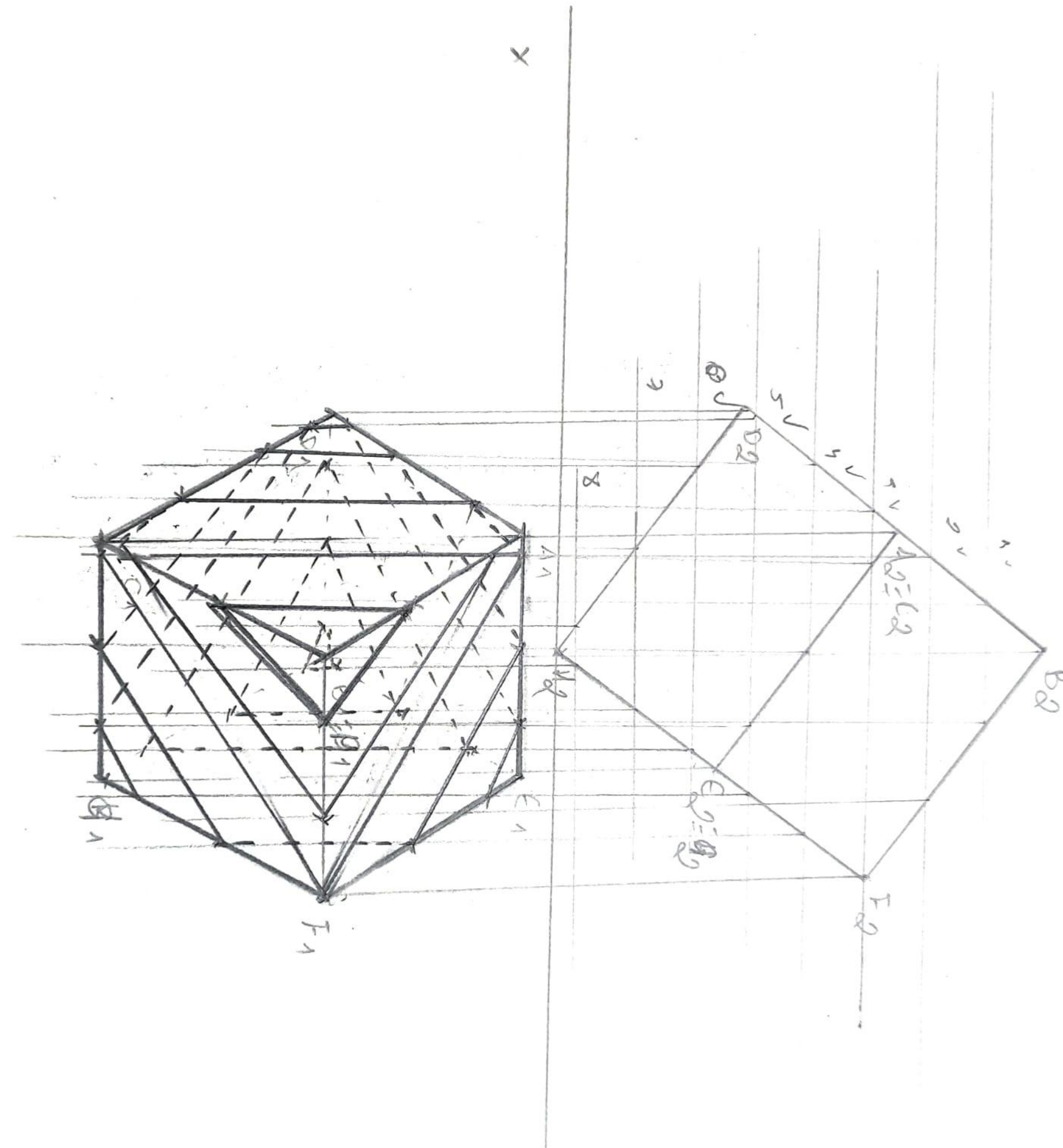

Exerc. 2

Projecção colada.

- Planets
- Interactions
- Morphological
- Evolution

Intervenes $\tilde{\Theta}$

Planen deliquens, deforierdes per robot de maiori ducile.

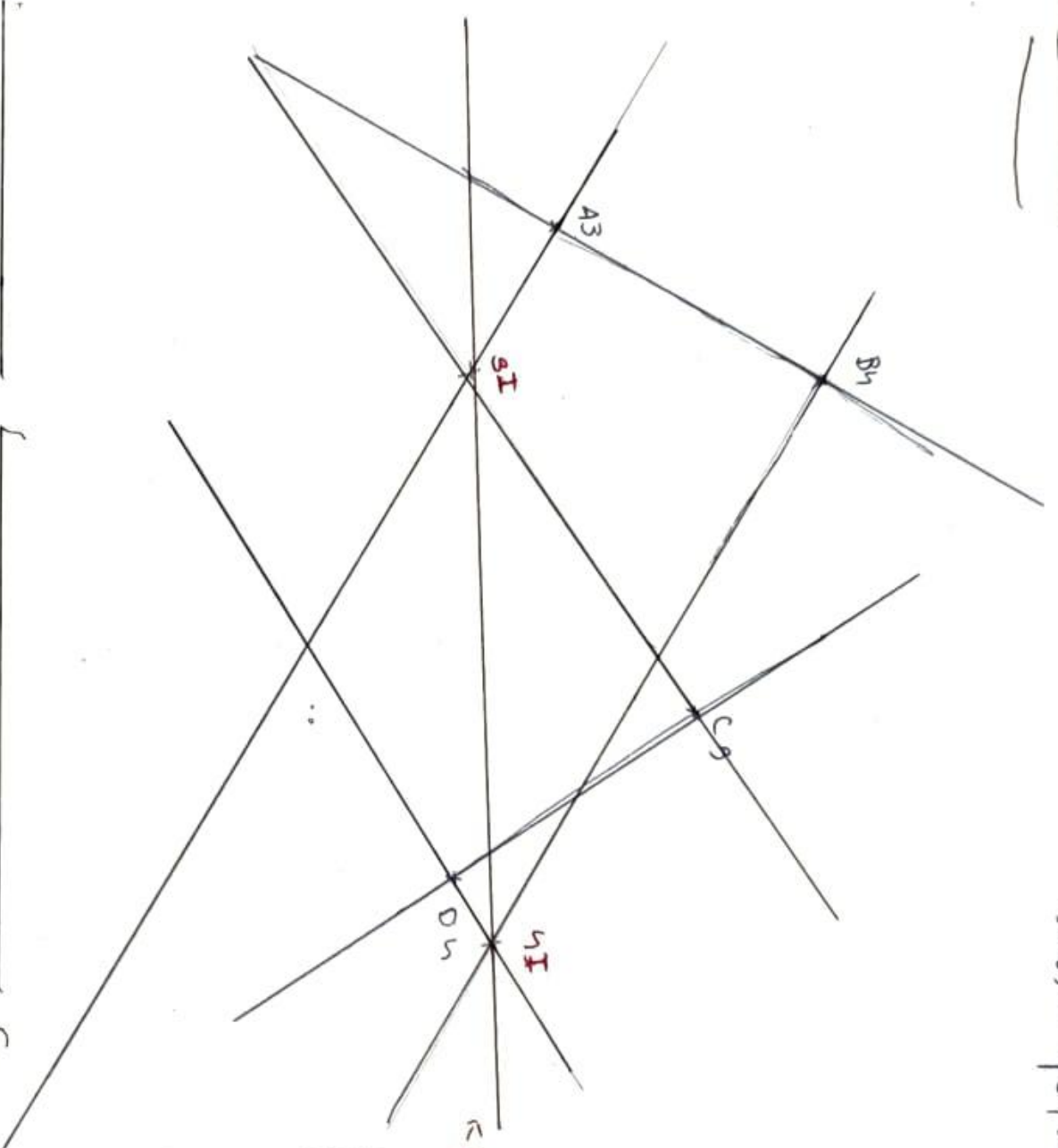

nas pontas do plano que tenham as mesmas cotas, tendo - as rotas auxiliares de maior declive, formando, essas rotas fagora 90° .
As pontas dessas rotas em que se intersectam com a ten outras planas, determina-se dein pontas da Roda I.

Rotas verticais ou paralelas

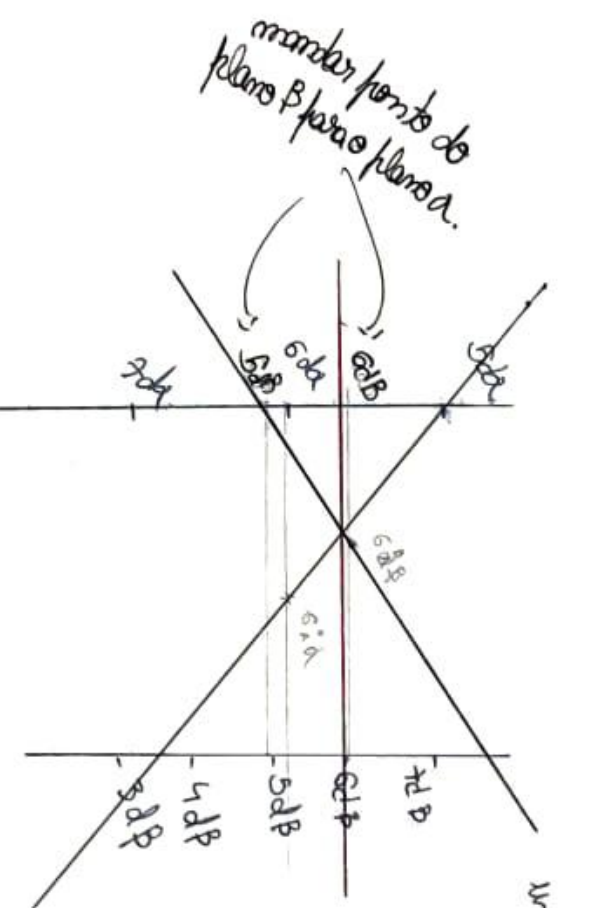
[illegible]

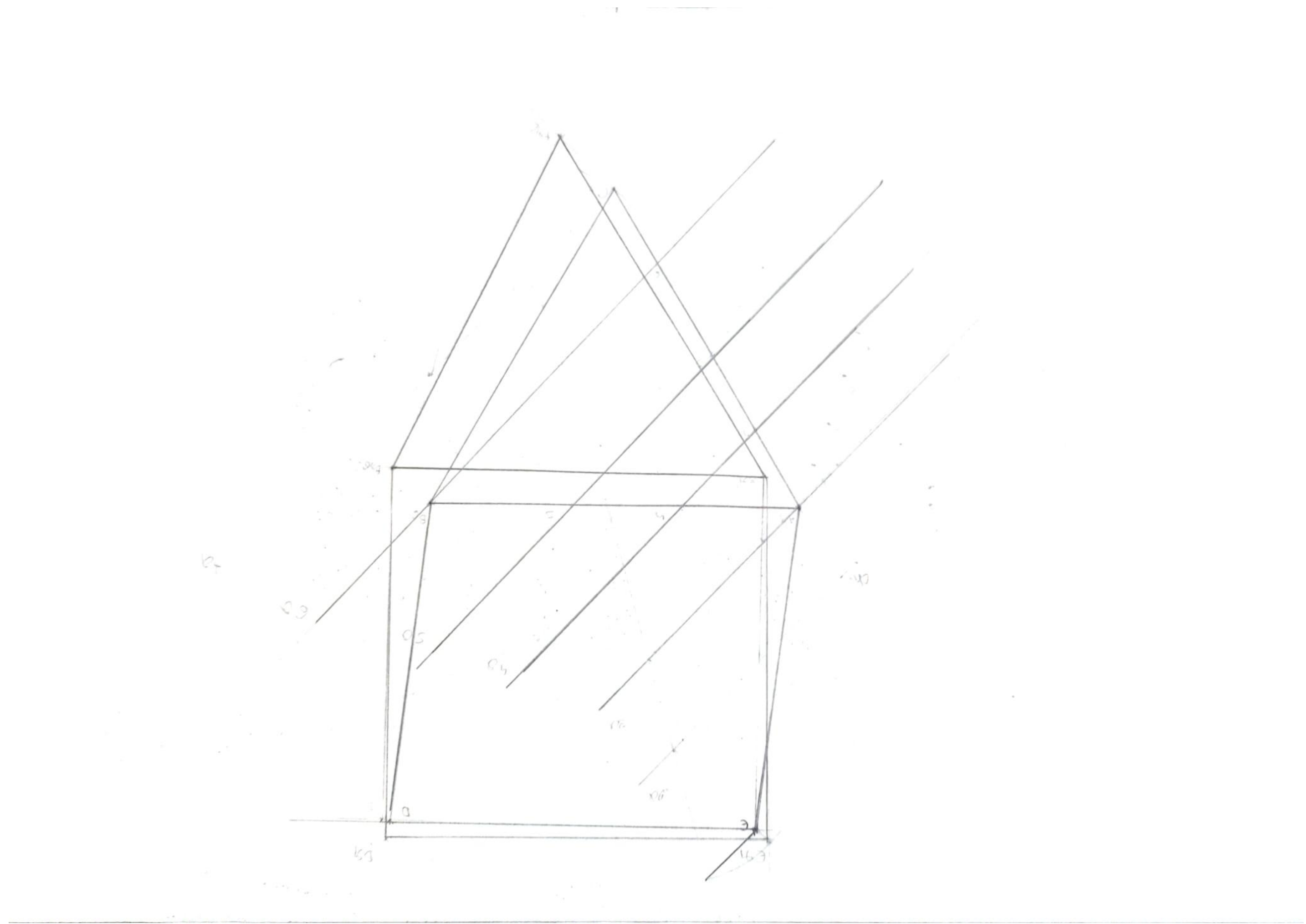

Exerc. 3

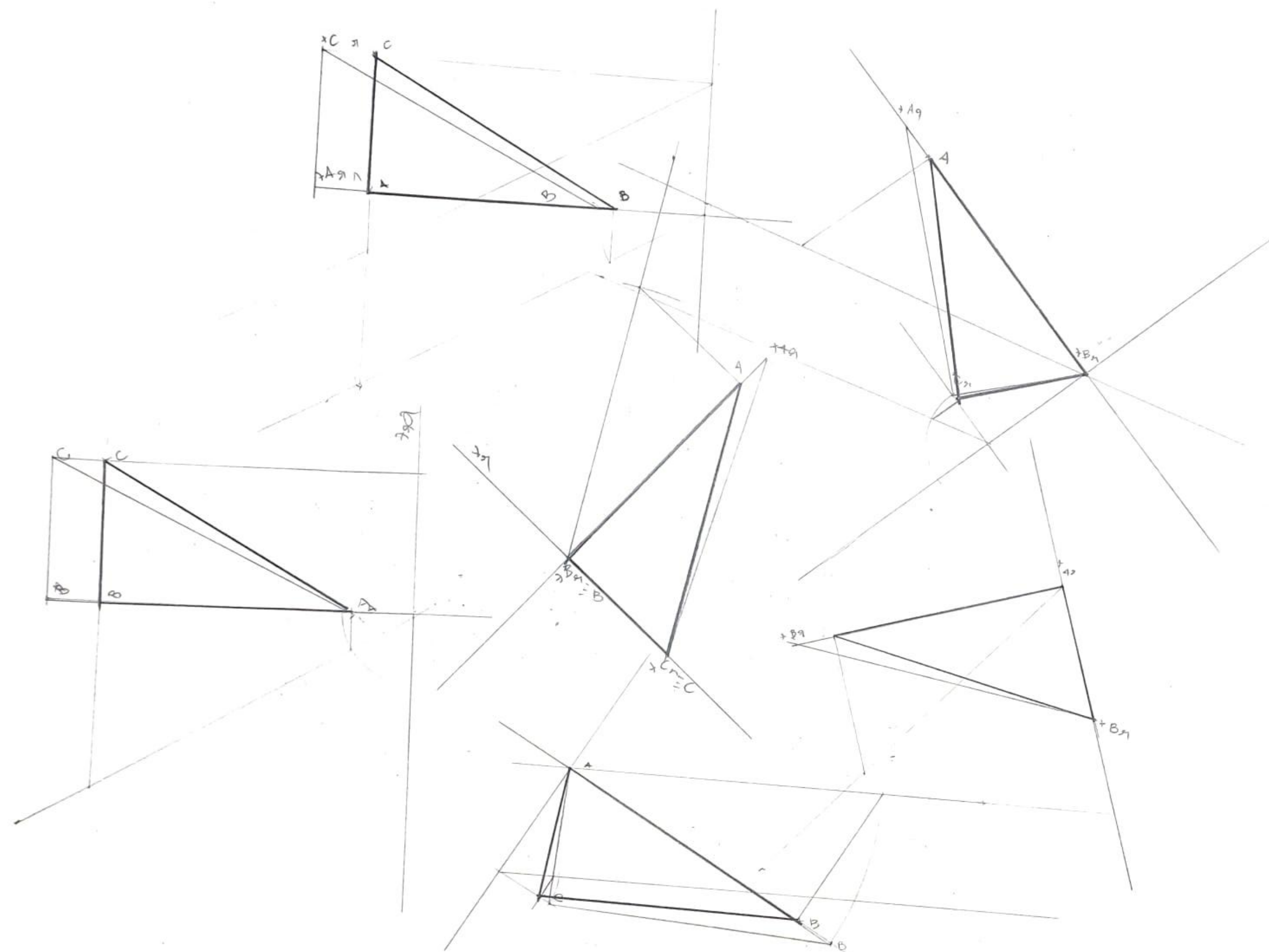

Exerc. 4

Interseção
do sólido com um plano

1cm \rightarrow unidade Altimétrica.

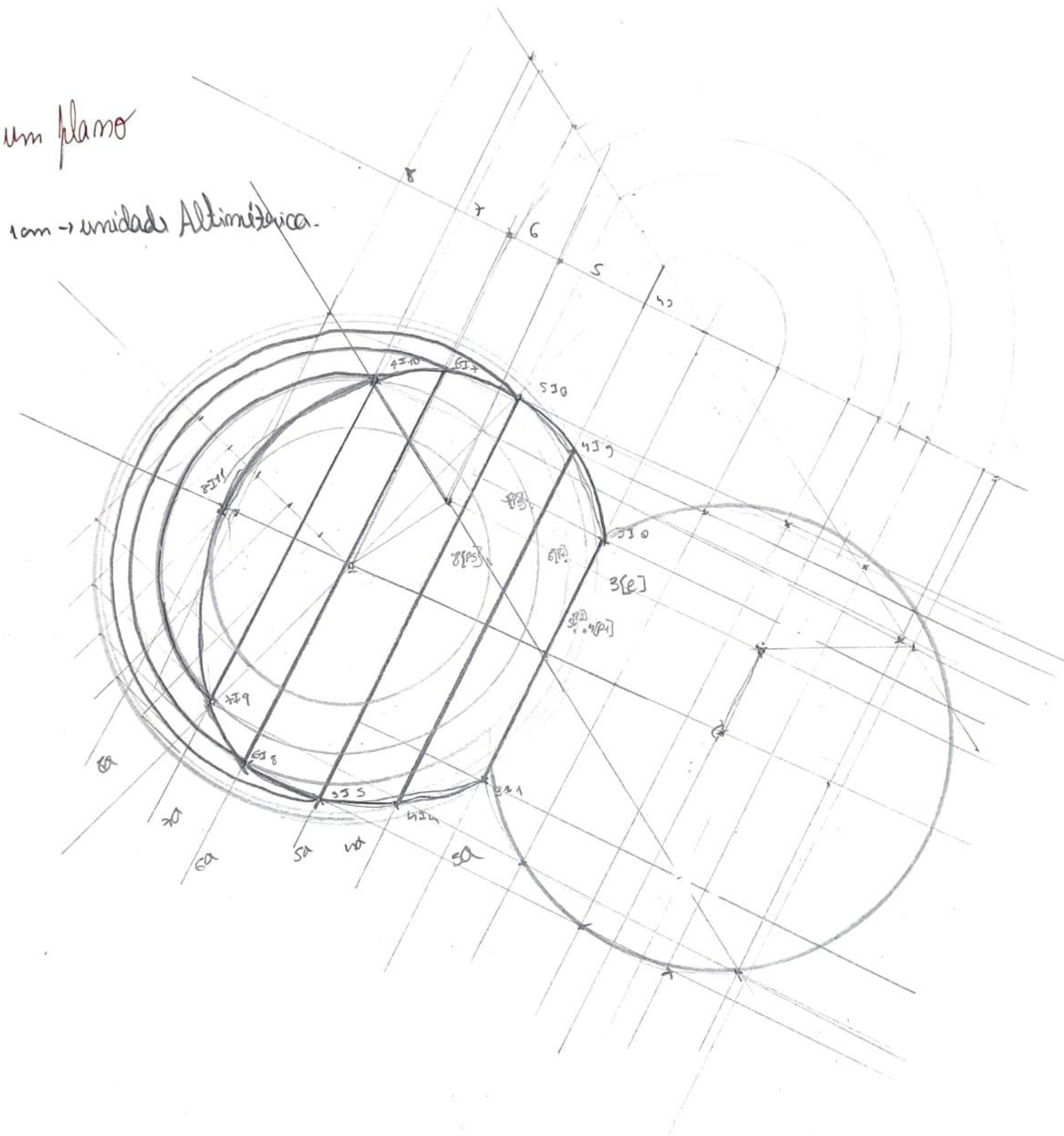

Exerc. 5

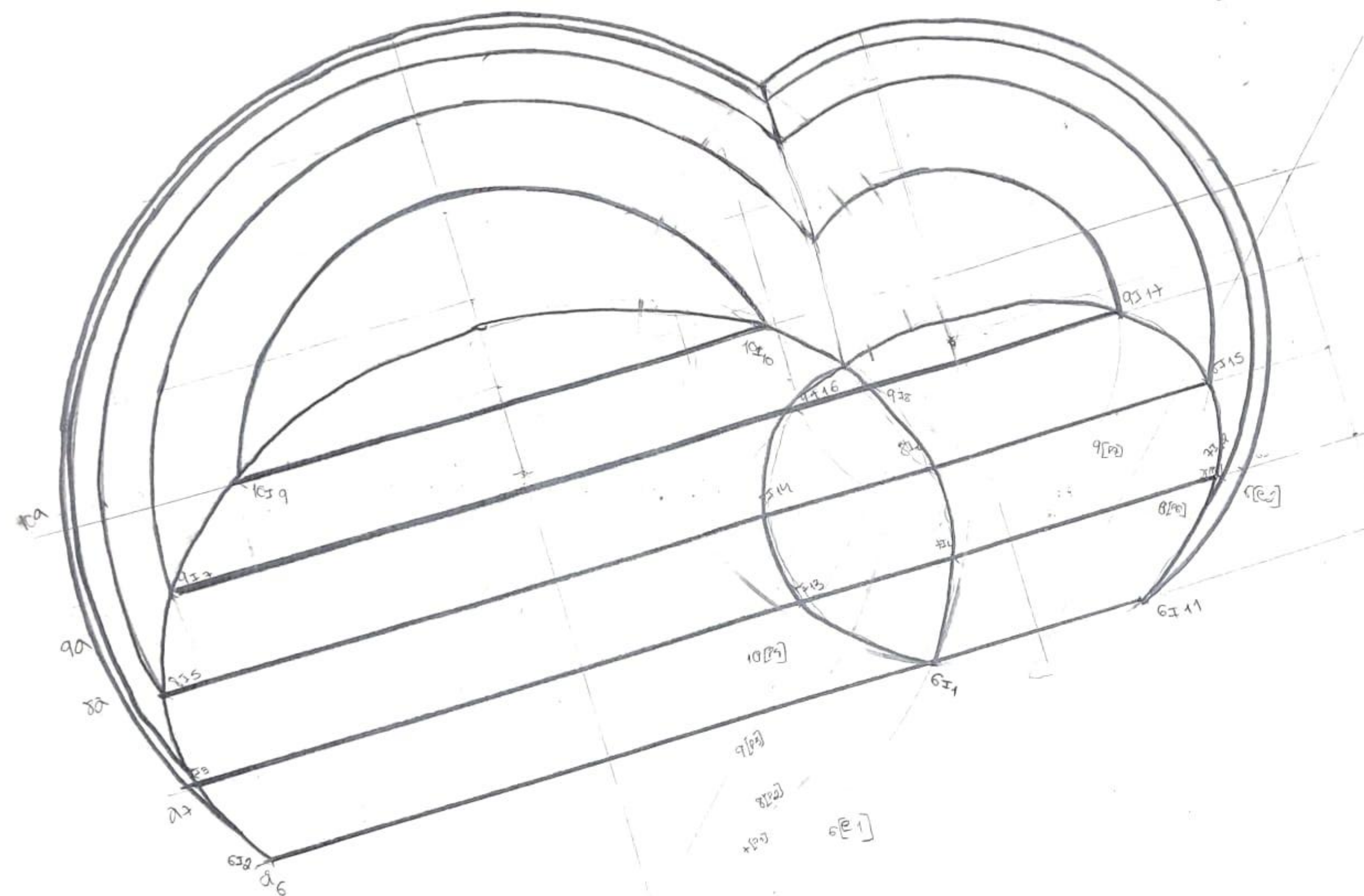

Exerc. 6

15.

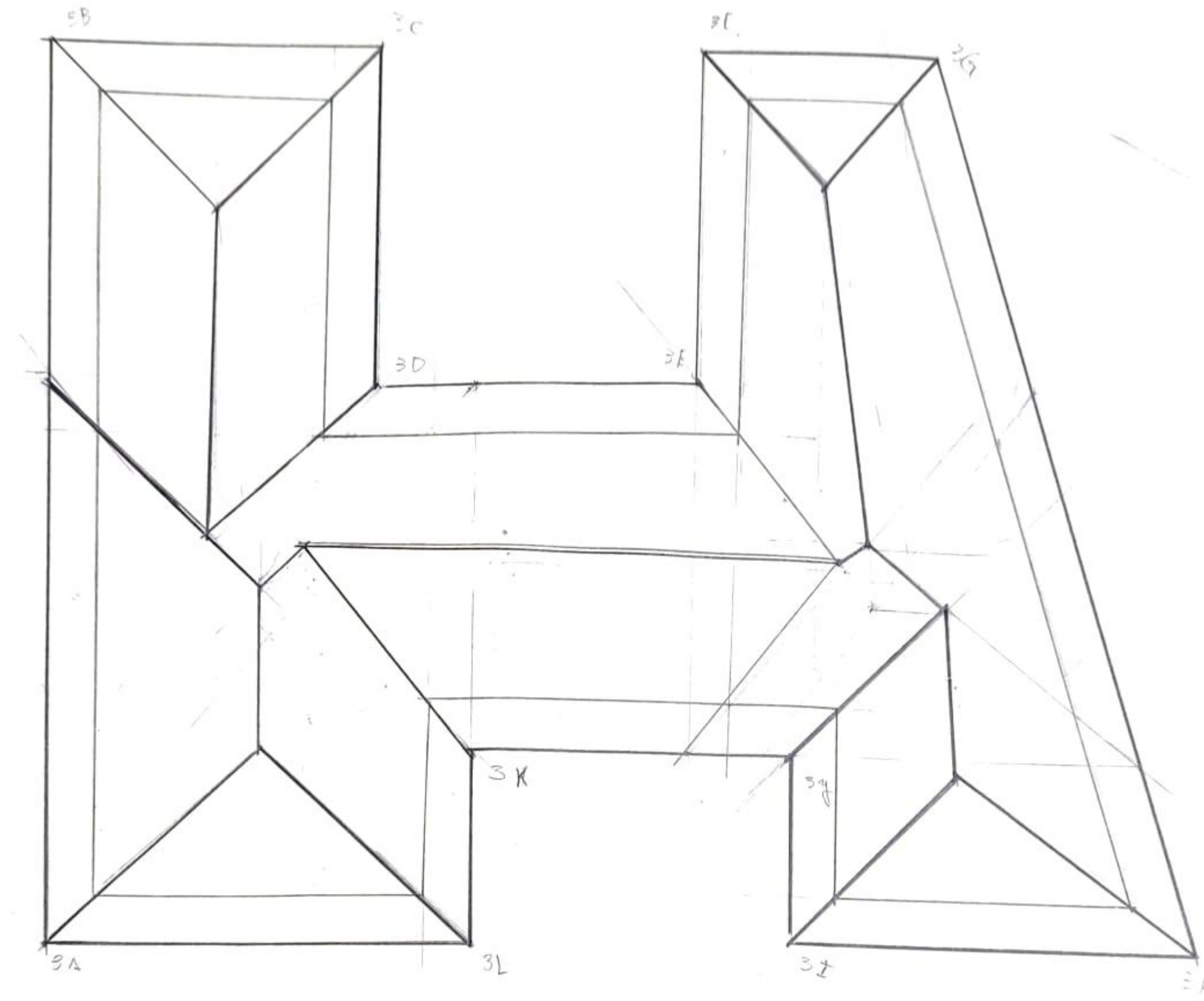

lida.

desenhadas.

linhas
construtoras

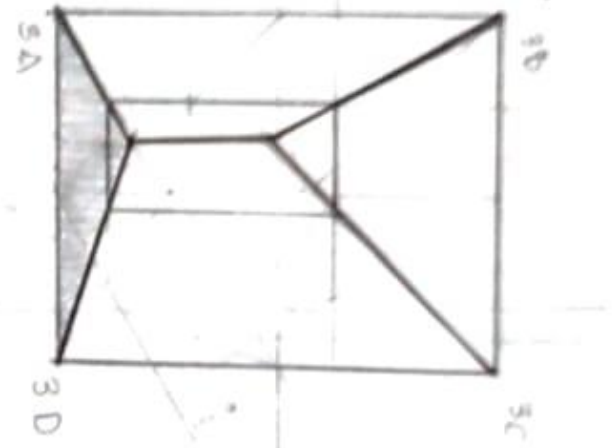

AB: 30°
BC: 30°
CD: 30°
DA: 30°

1cm - L. Altimetria



linhas sem i. medida

1cm - L. Altimetria - 4 cm i. medida

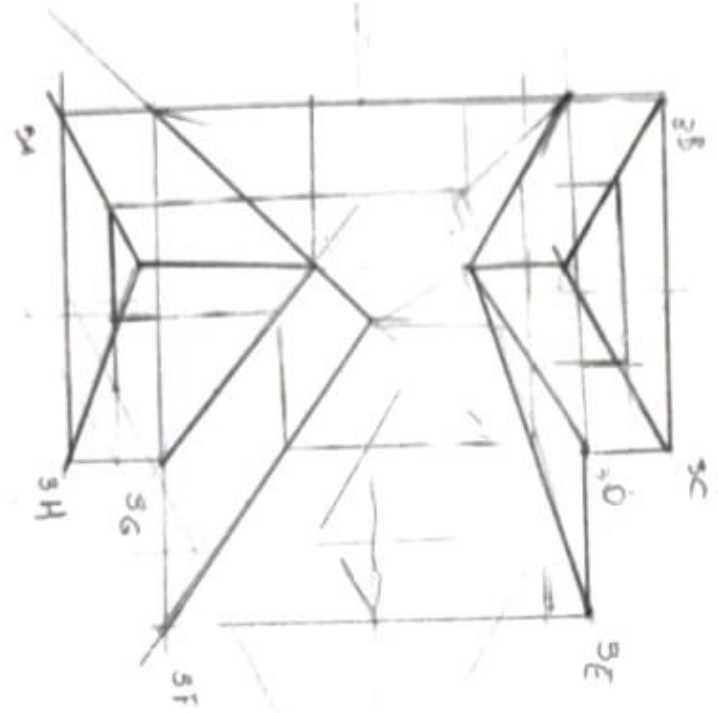

4E: 45°
BC: 100°
CD: 60°
DE: 60°
EF: 100°
FG: 30°
GH: 30°
HA: 30°



Apontamentos de aula -2

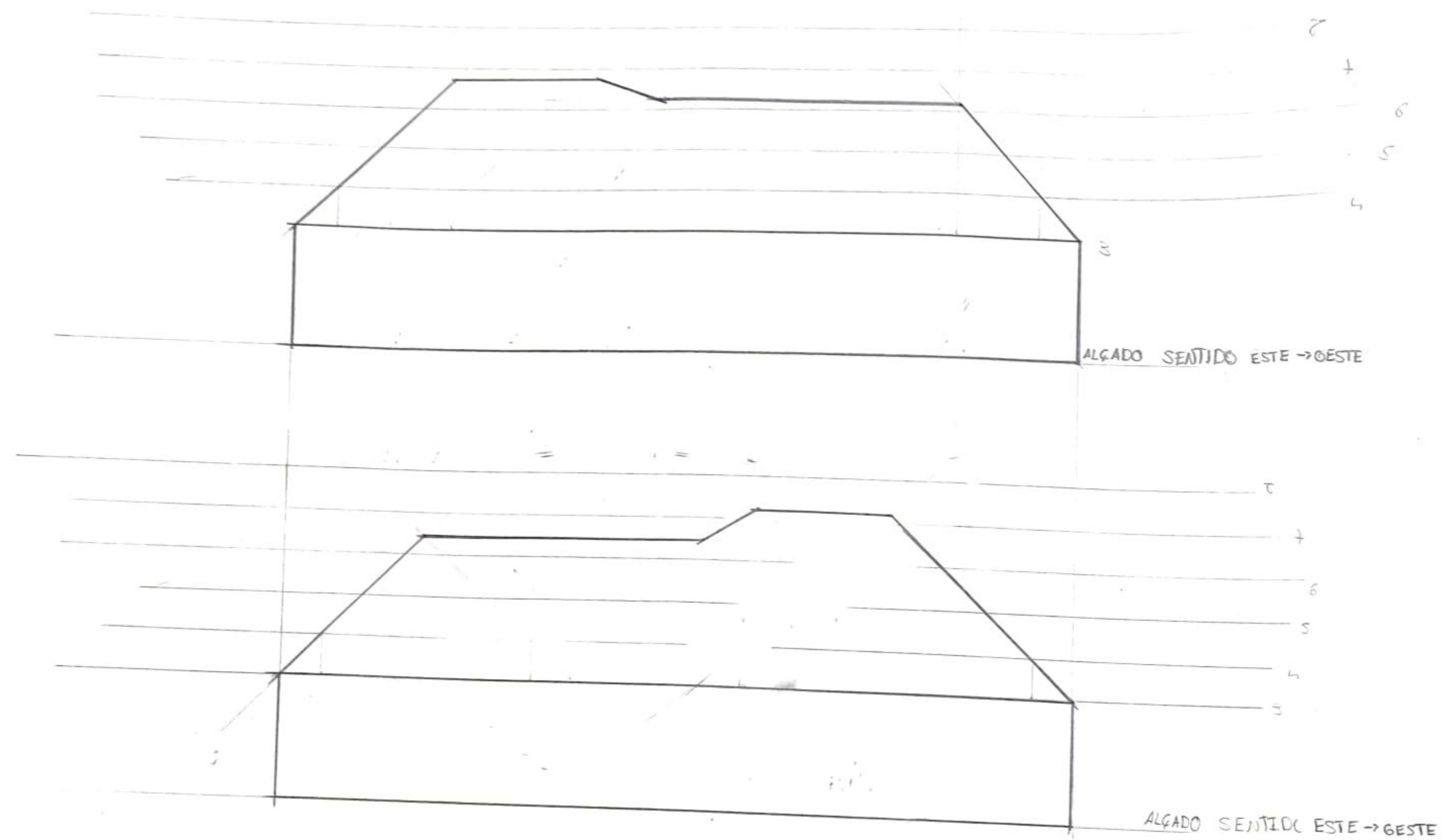

Exerc. 8

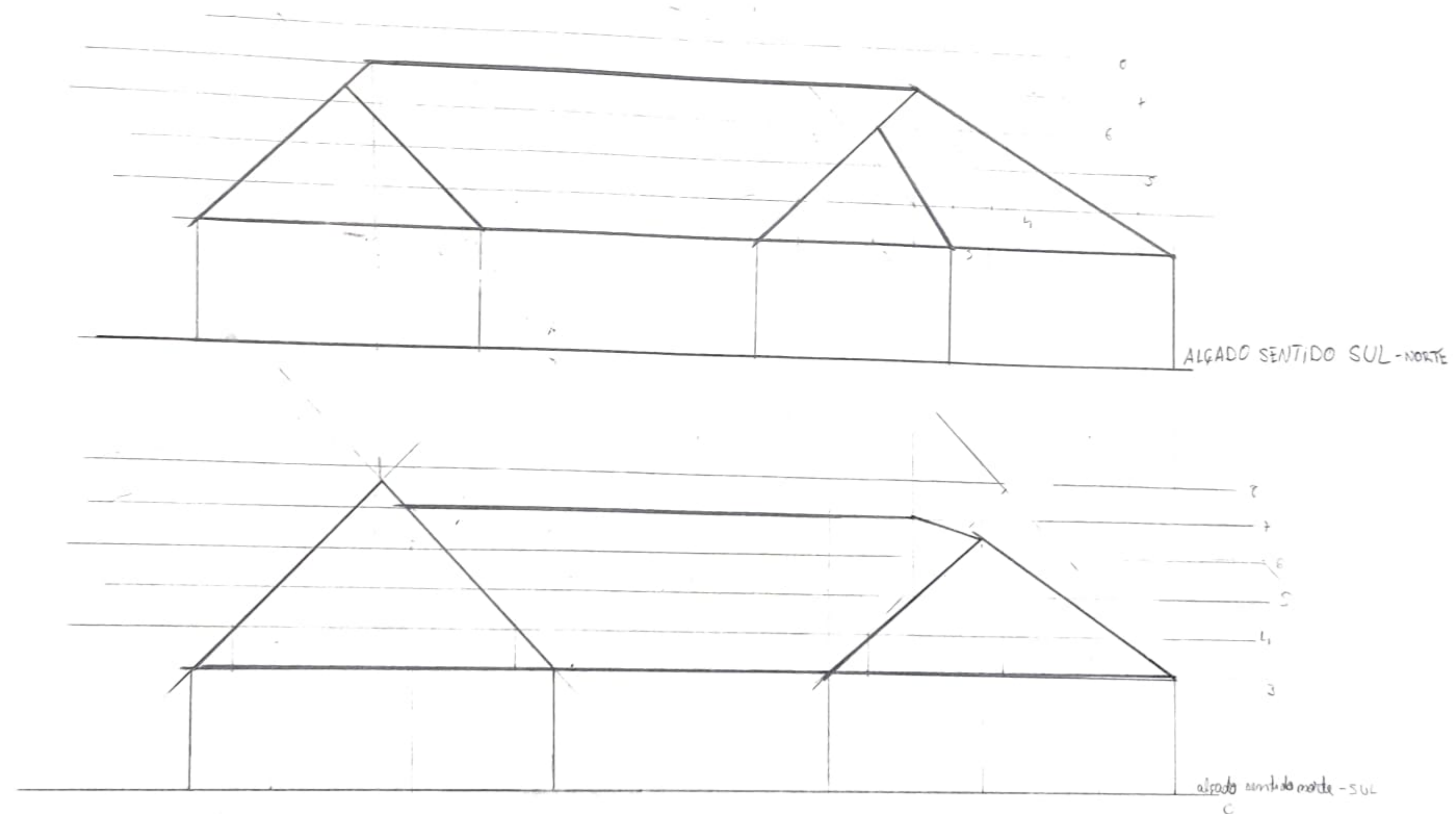

Exerc. 9

Don. AST - 1cm

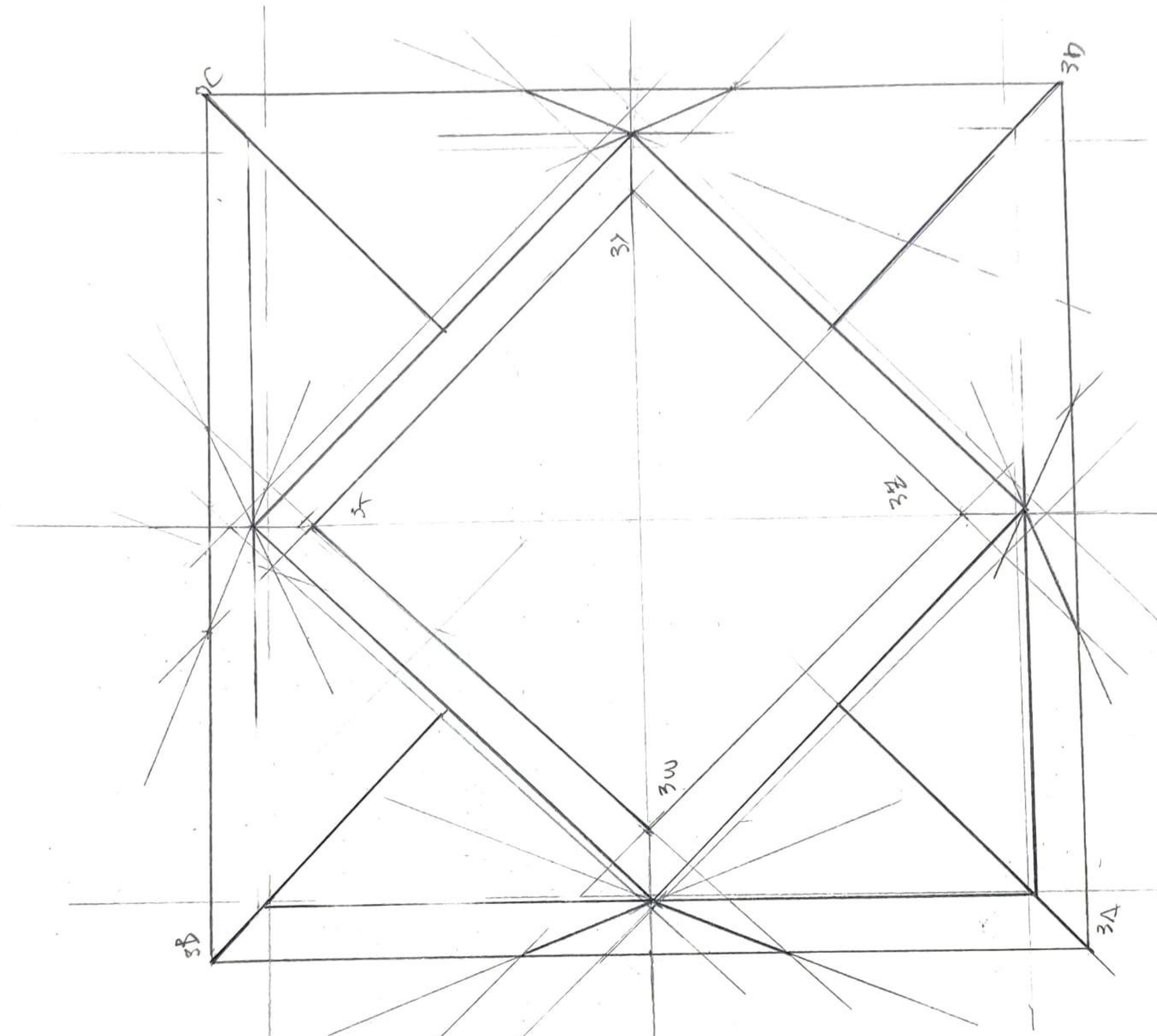

Exerc. 10

$AB=1$
 $BC=2$
 $CD=1,5$
 $DA=0,5$
 $WX=0,5$
 $XY=2$
 $YZ=1$
 $ZW=0,5$

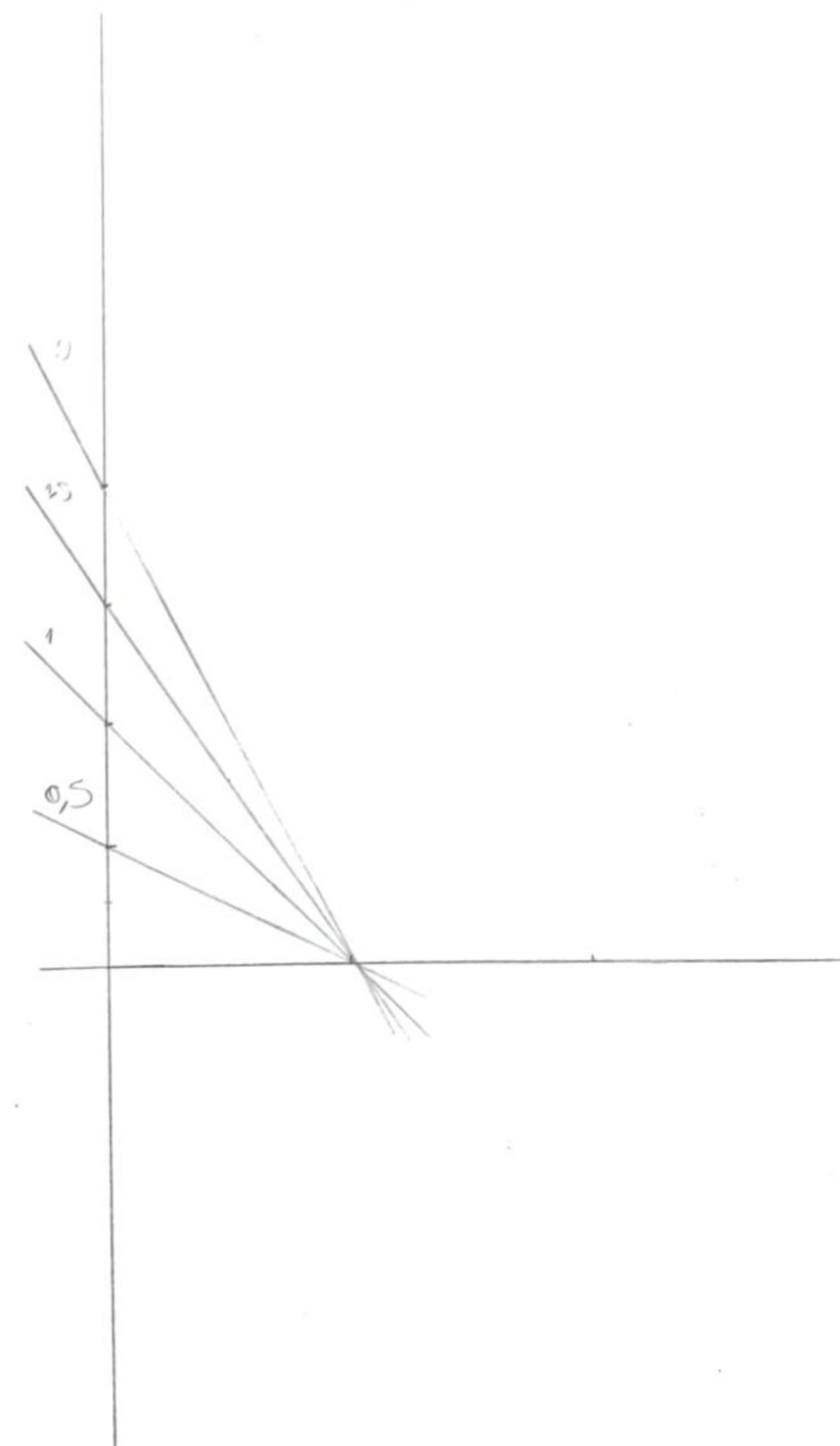
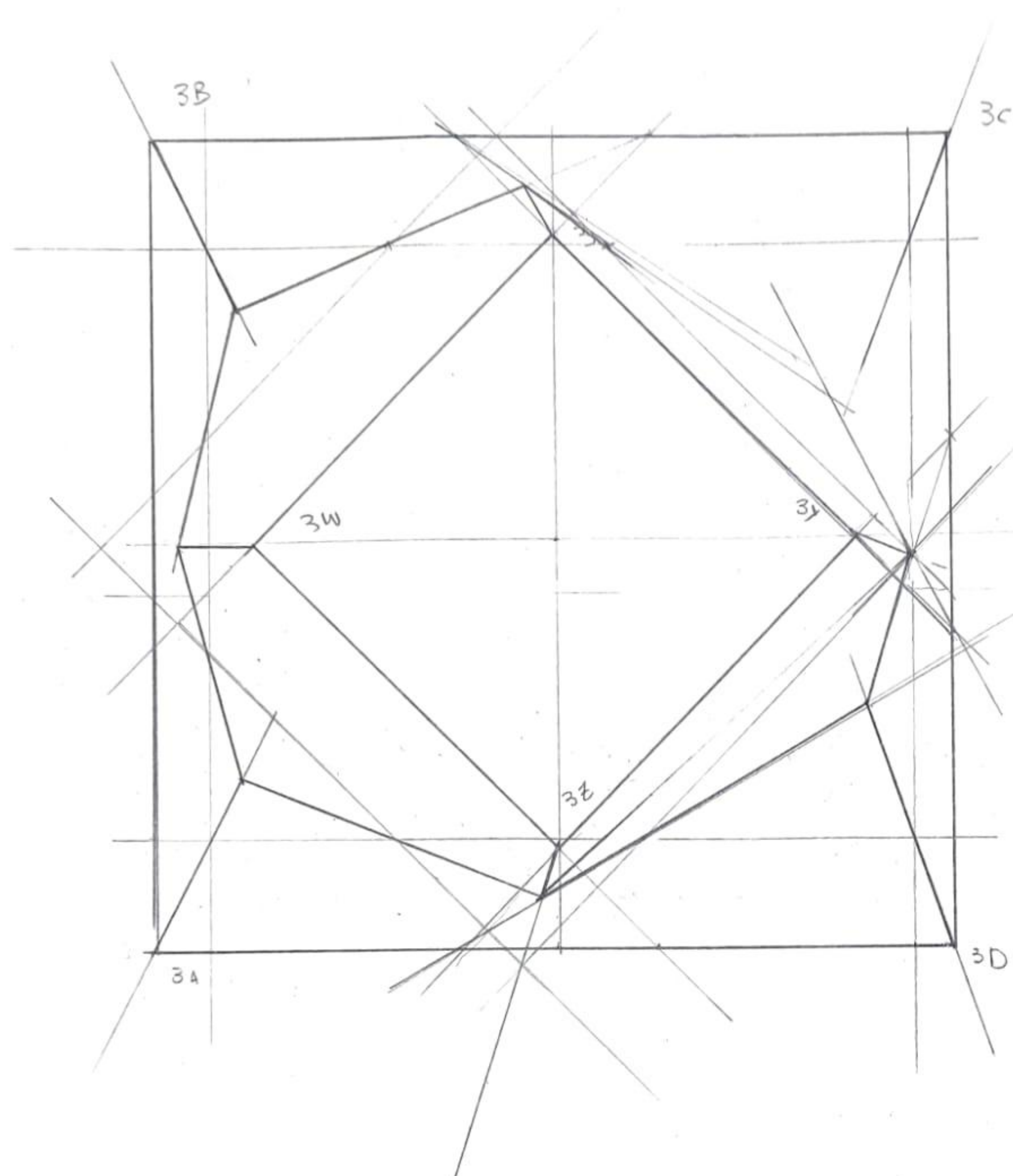

Exerc. 11

~~Falha~~
cobertura
com 2 Pontes com
cota diferente

cota

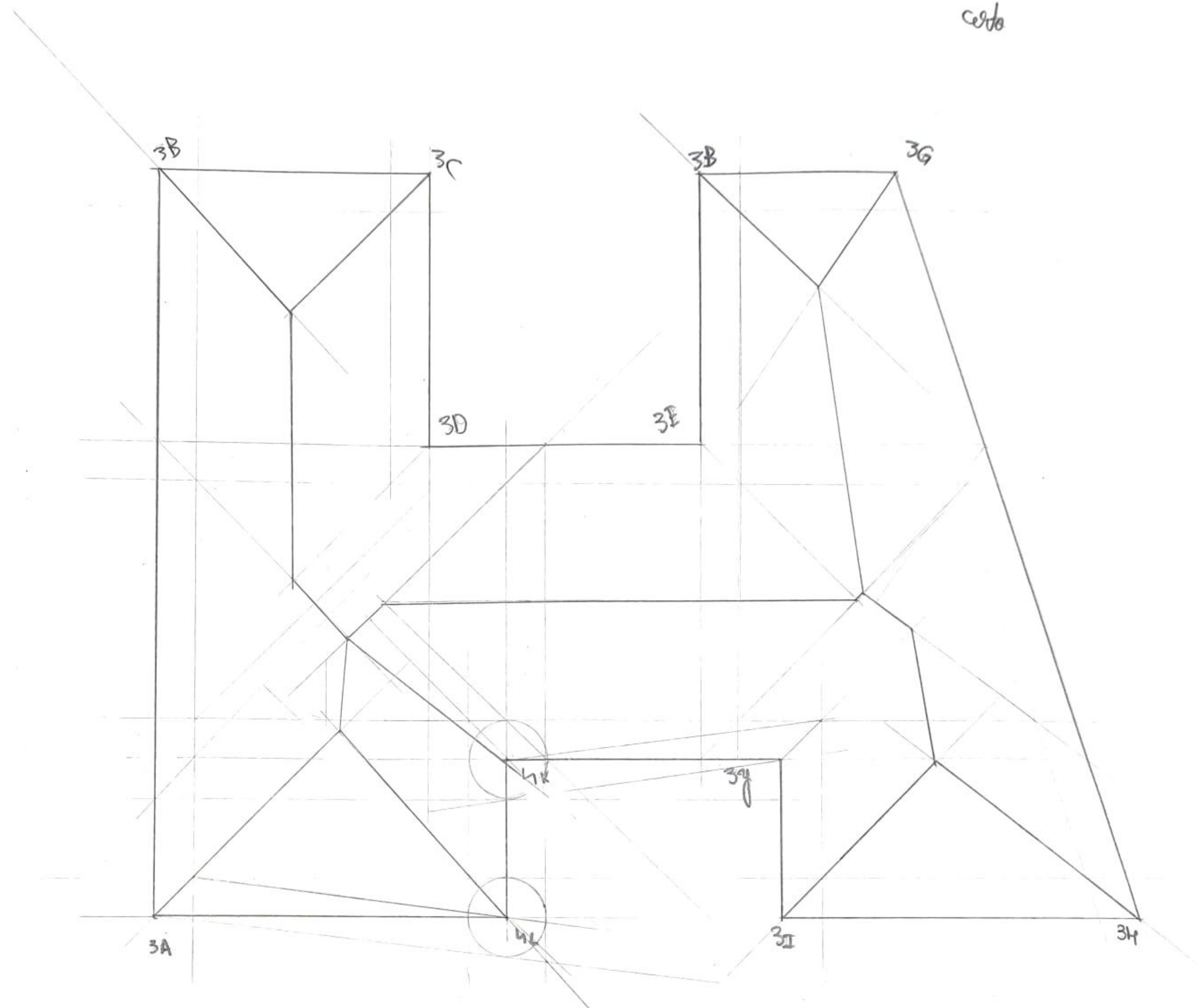

Exerc. 12

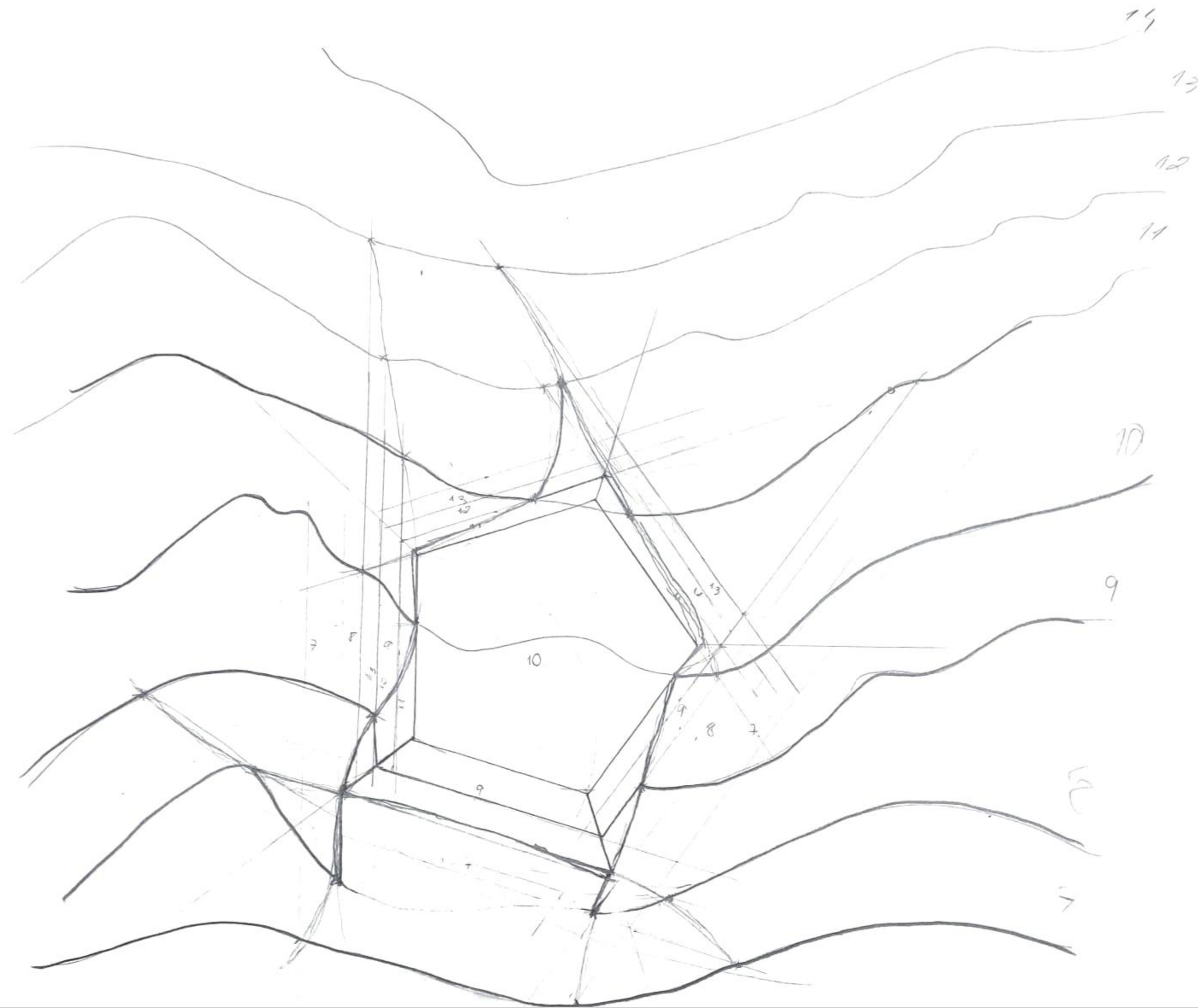

Exerc. 13

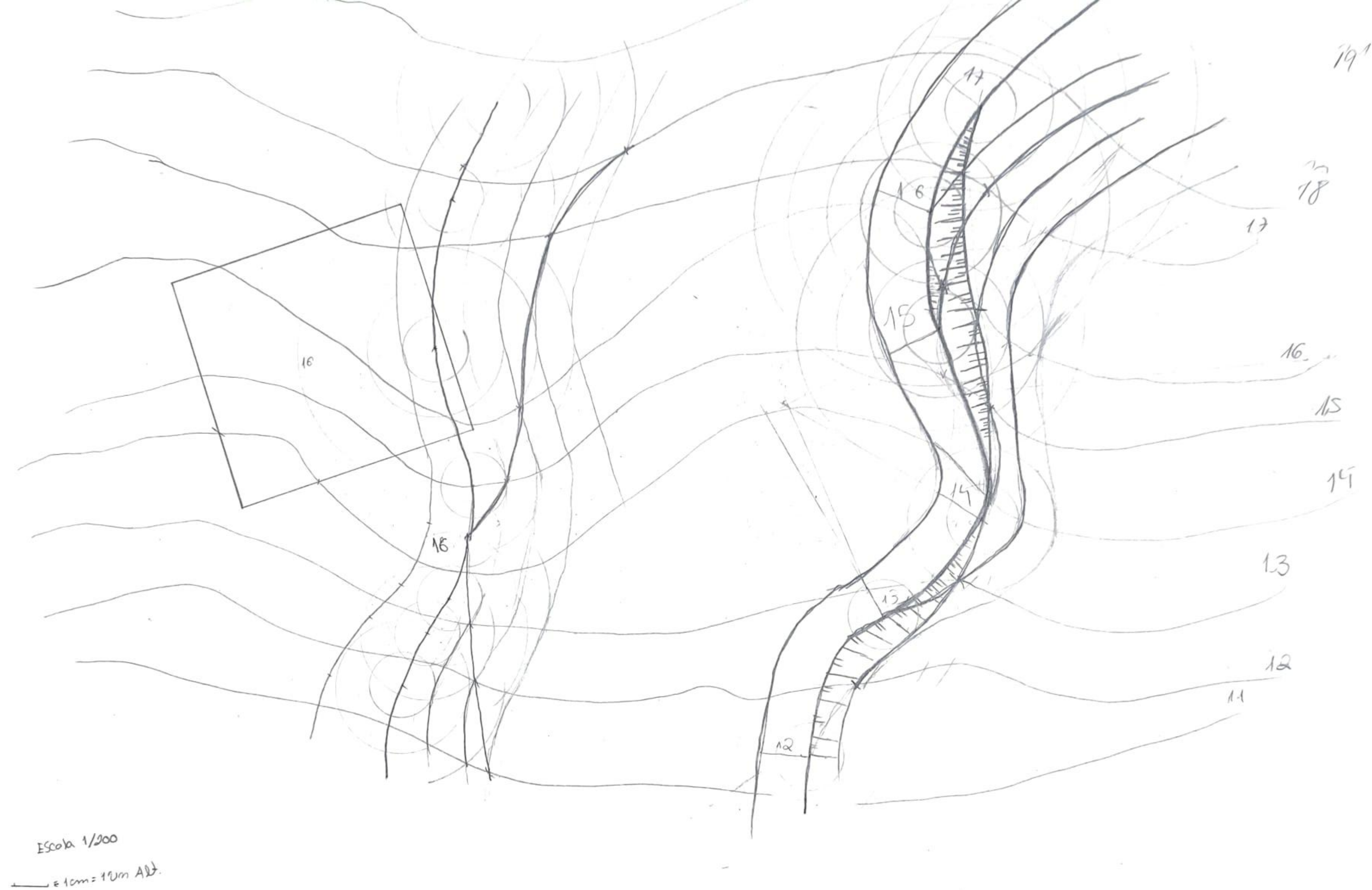

Exerc. 14