

# Modelação e Visualização Tridimensional em Arquitectura

**U** LISBOA

UNIVERSIDADE  
DE LISBOA



FACULDADE DE ARQUITETURA  
UNIVERSIDADE DE LISBOA

Mestrado Integrado em Arquitectura  
Ano Lectivo 2022-2023 2º Semestre  
Docente - Nuno Alão 3º Ano



2021 1448



JOANA RAFAELA LINHEIRO BASTOS

**U** LISBOA

UNIVERSIDADE  
DE LISBOA



FACULDADE DE ARQUITETURA  
UNIVERSIDADE DE LISBOA

**MVTA**

Mestrado Integrado em Arquitectura  
Ano Lectivo 2022-2023 2º Semestre  
Docente - Nuno Alão 3º Ano



INDICE

Exerc. 1.1 - Superfície Parabólica.....	slide 4 e 5
Exerc. 2 – Figuras tridimensionais – Parte 1.....	slide 6 e 7
Exerc. 2 – Figuras tridimensionais – Parte 2 .....	slide 8 e 9
Exerc. 3 – Secções Planas.....	slide 10
Exerc. 3.1 – Tabuleiro de Xadrez.....	slide 10
Exerc. 4 – Loft.....	slide 12
Exerc. 5 – Museu Solomon R. Guggenheim .....	slide 13

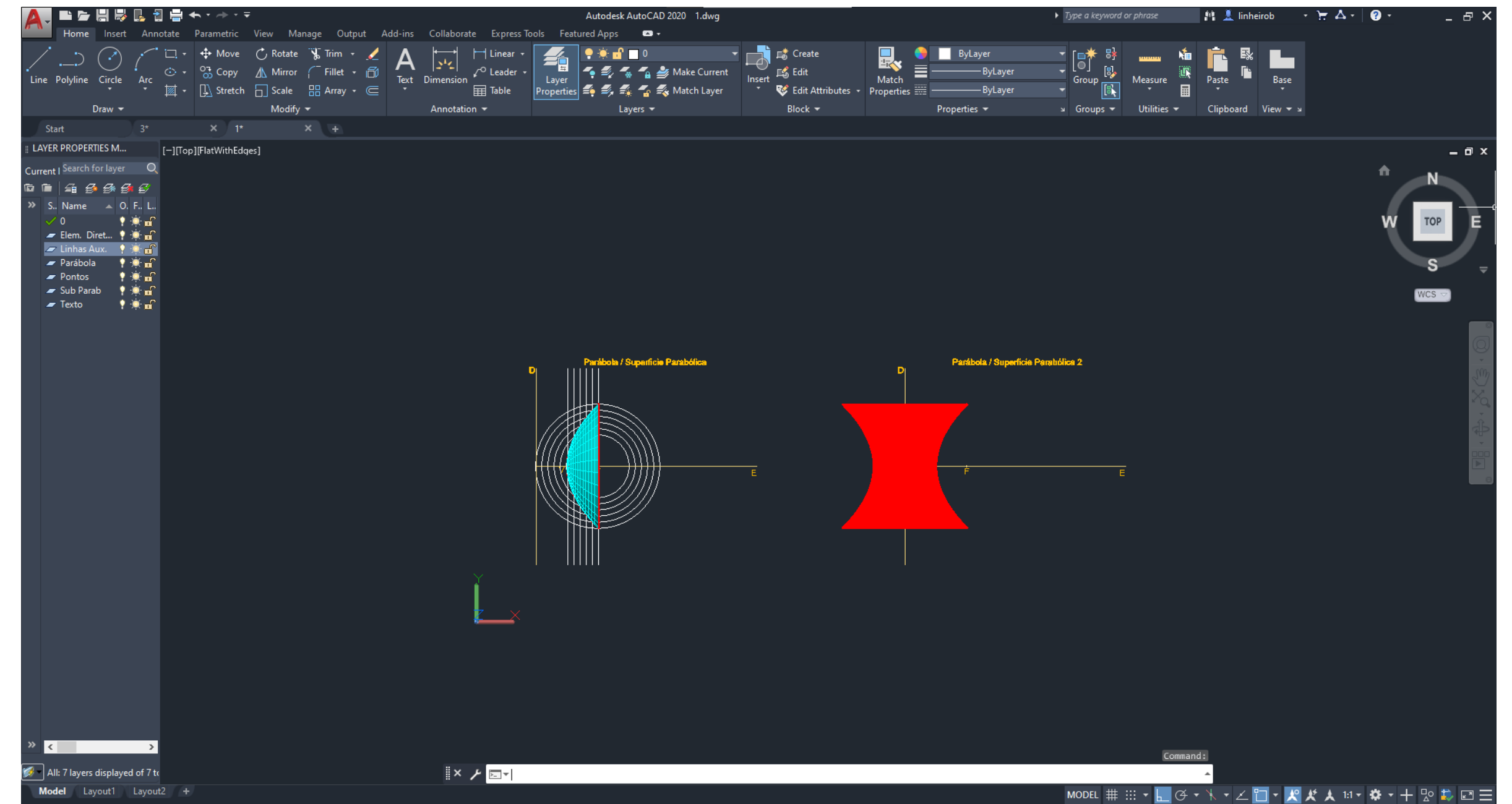
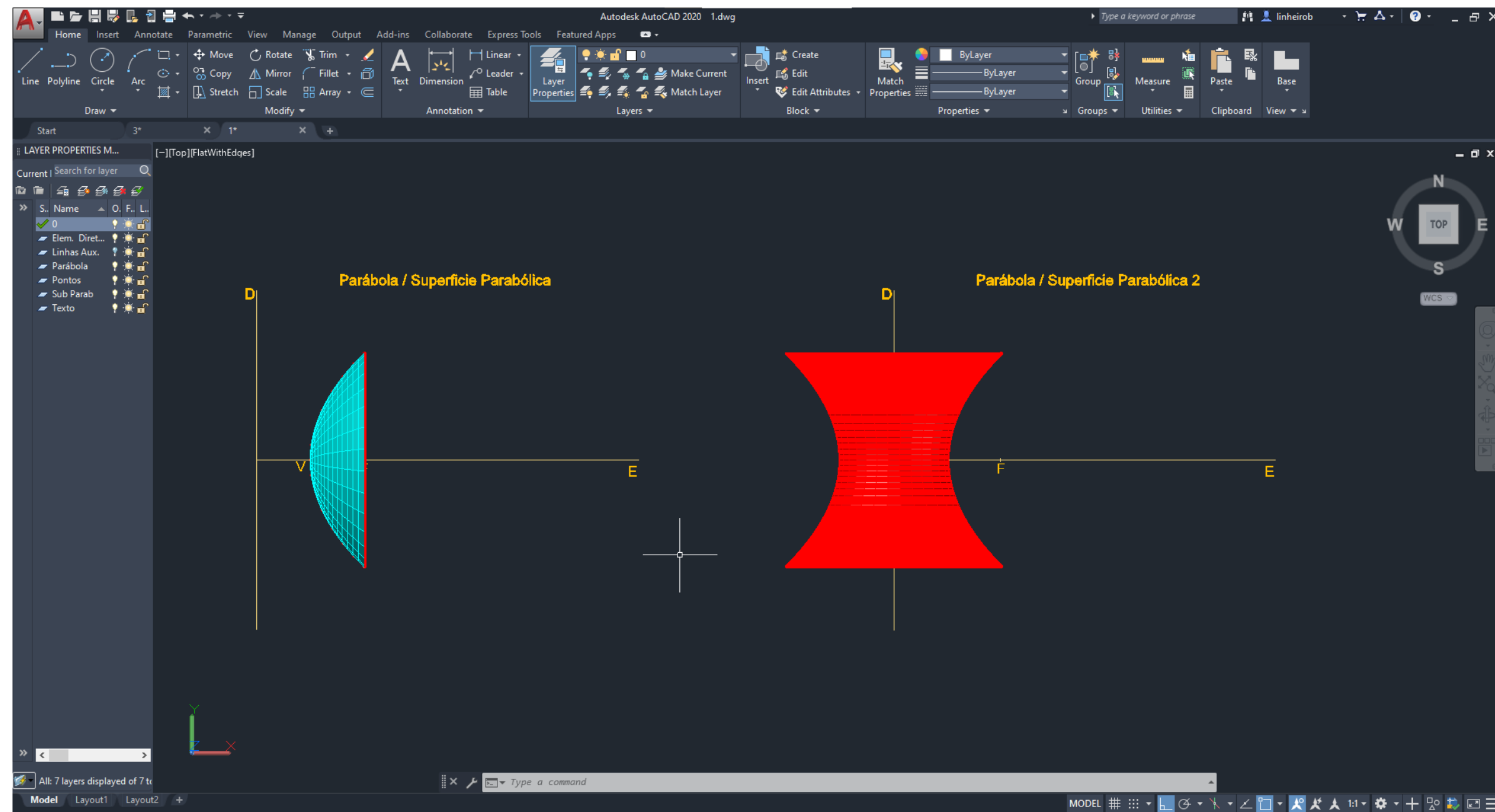

# Exerc. 1.1 - Superfície Parabólica

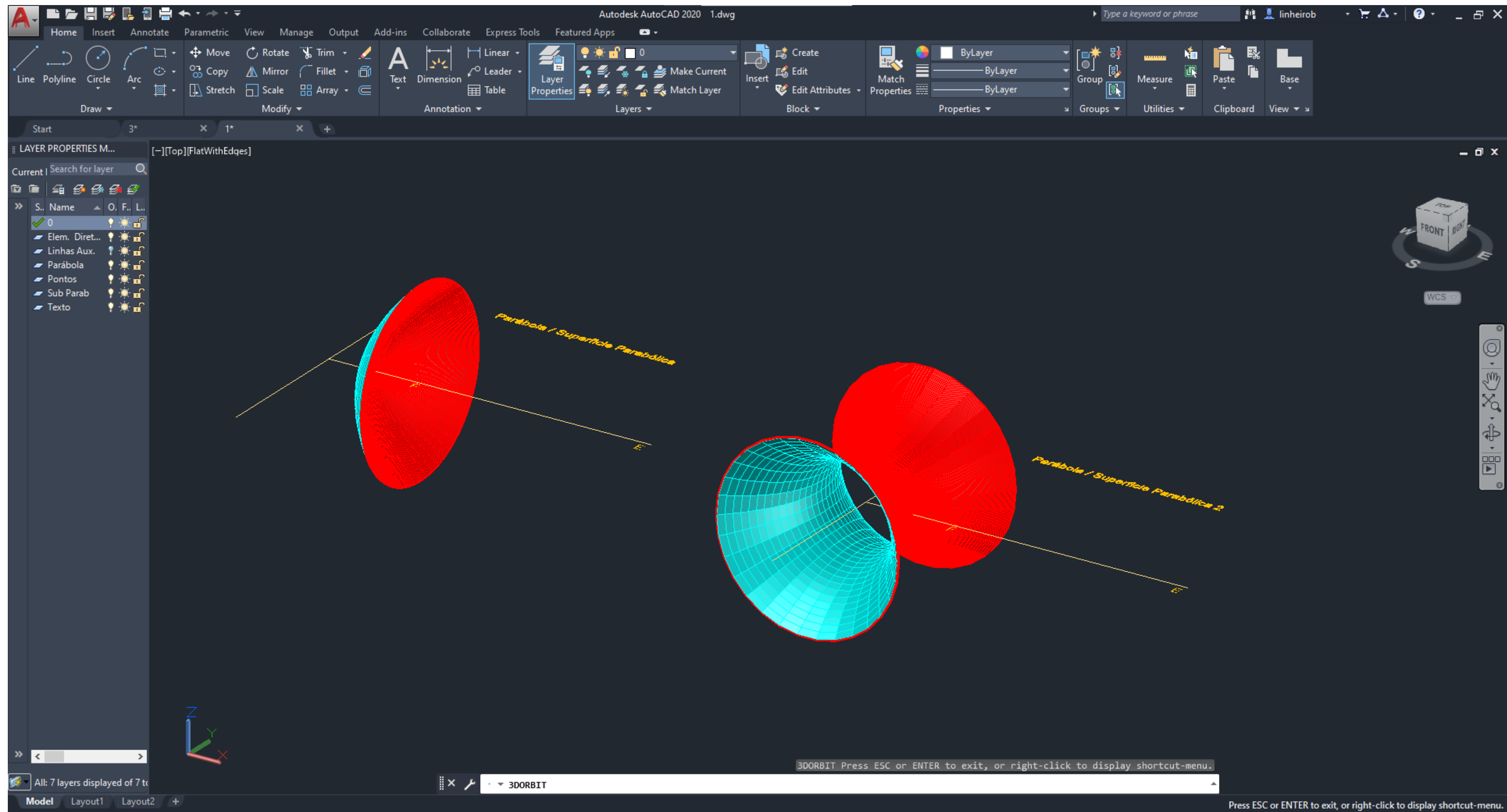

# Exerc. 1.1 - Superfície Parabólica

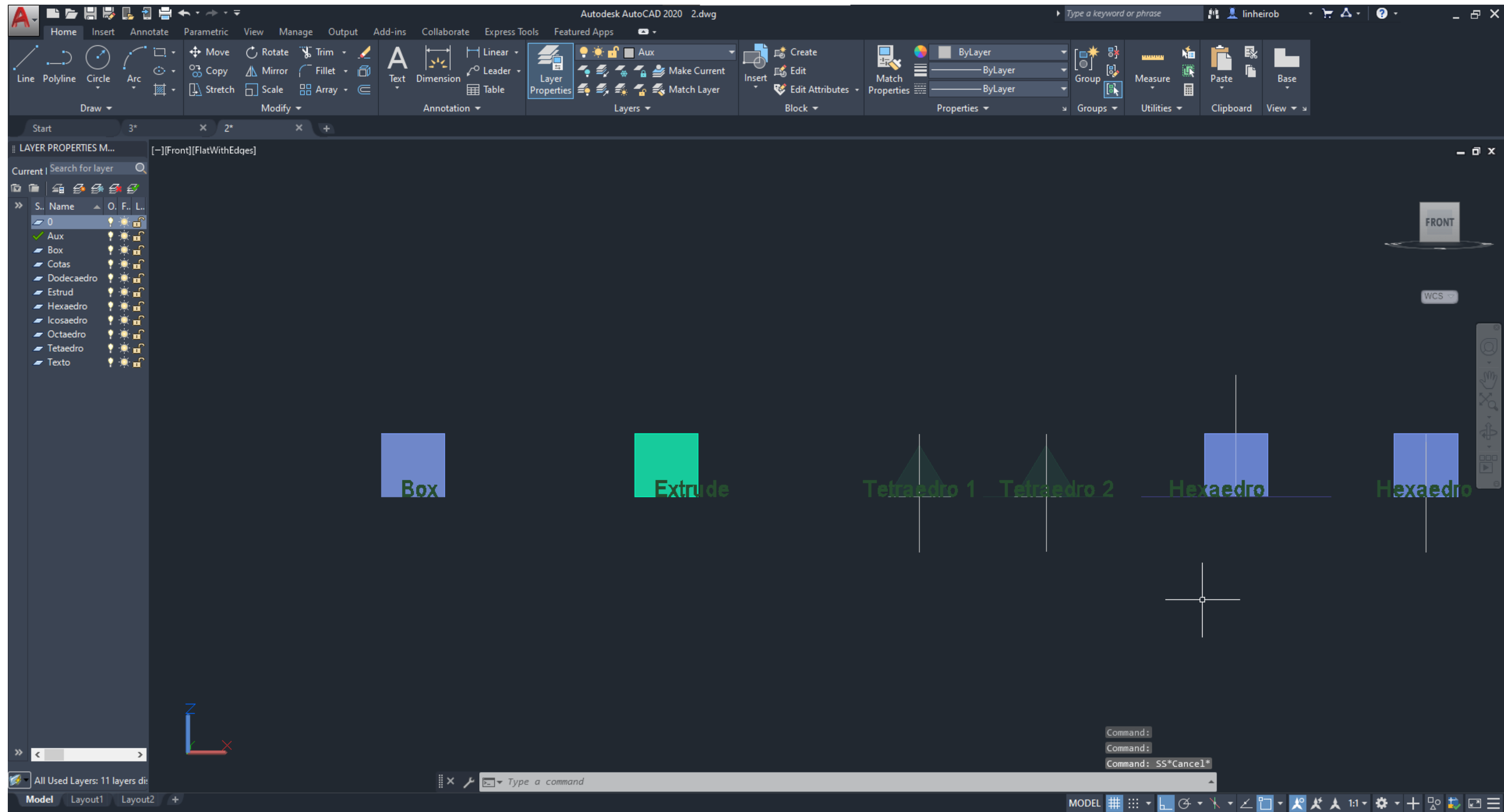

# Exerc. 2 – Figuras tridimensionais – Parte 1

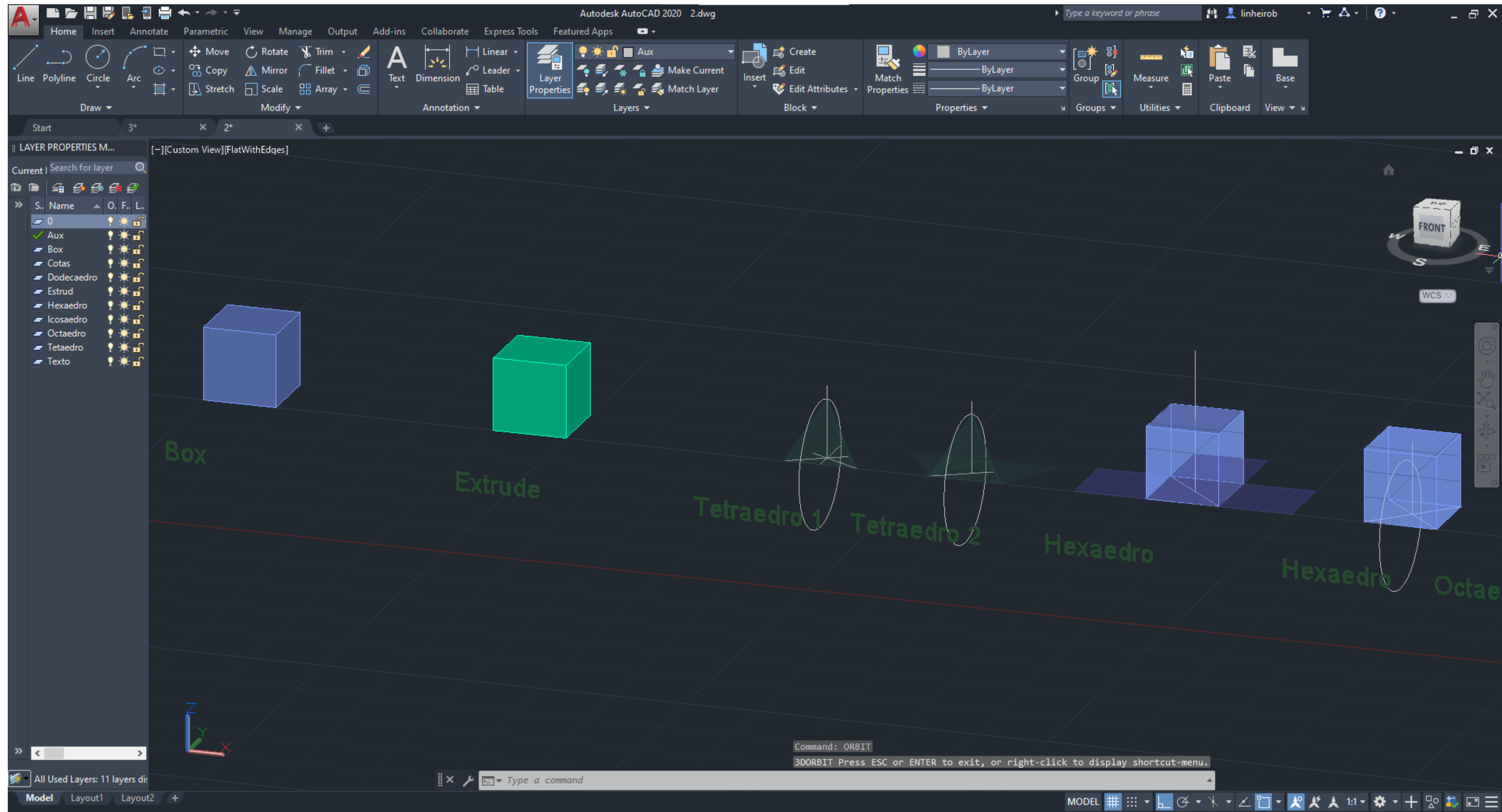

# Exerc. 2 – Figuras tridimensionais – Parte 1

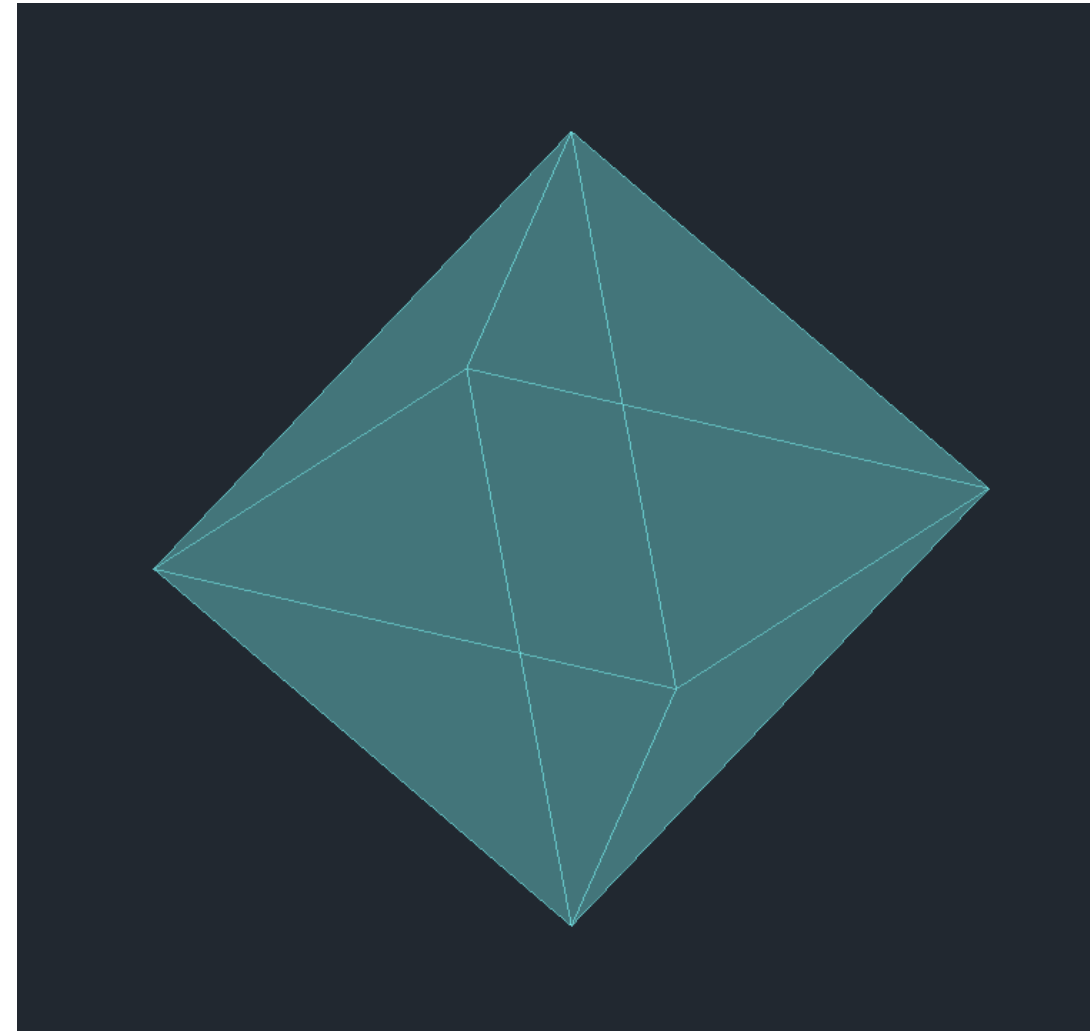

Fig. 1: Octaedro



Fig. 2: Dodecaedro (TPC)



Fig. 3: Icosaedro

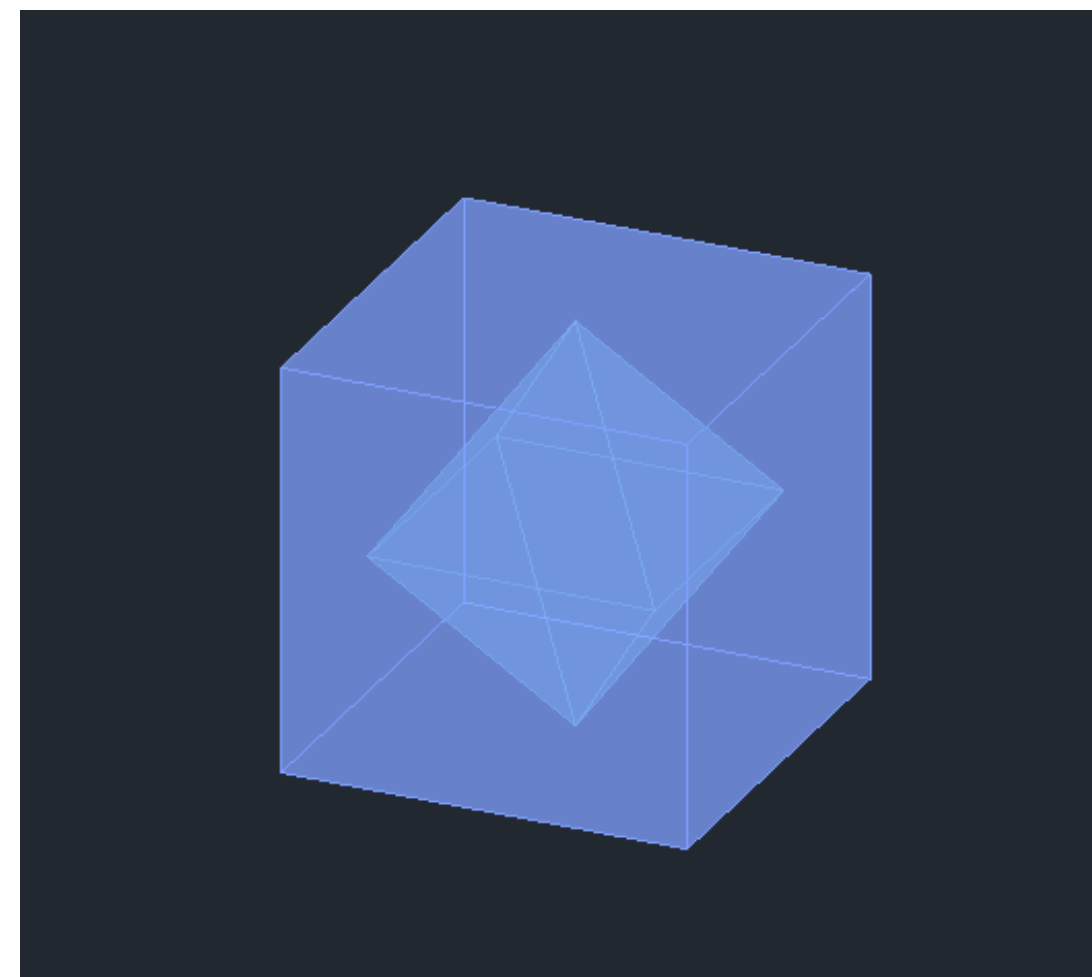

Fig. 4: Hexaedro intersetado com Octaedro(TPC)



Fig. 5: Dodecaedro intersetado com Icosaedro (TPC)

# Exerc. 2 – Figuras tridimensionais – Parte 2



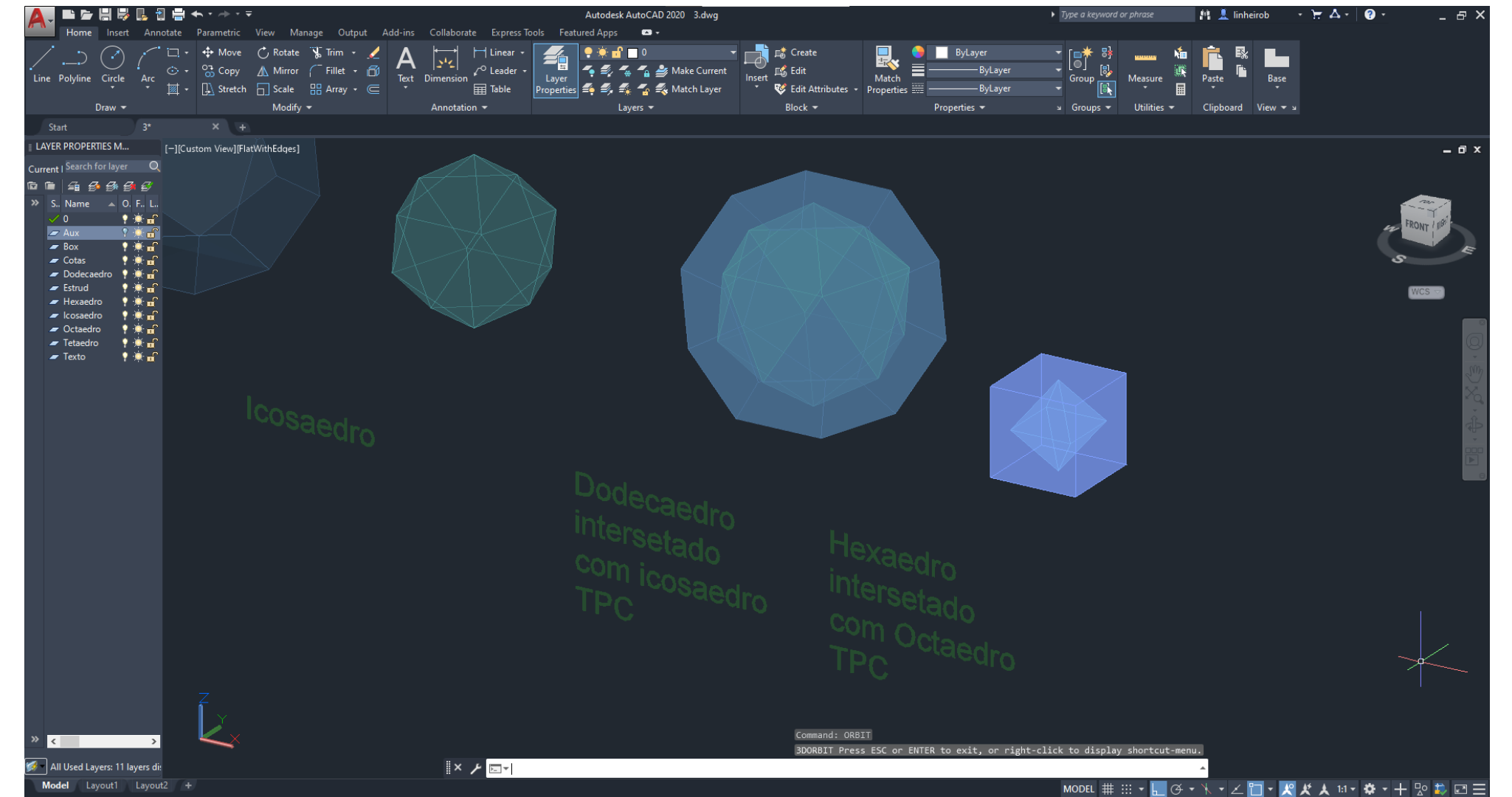
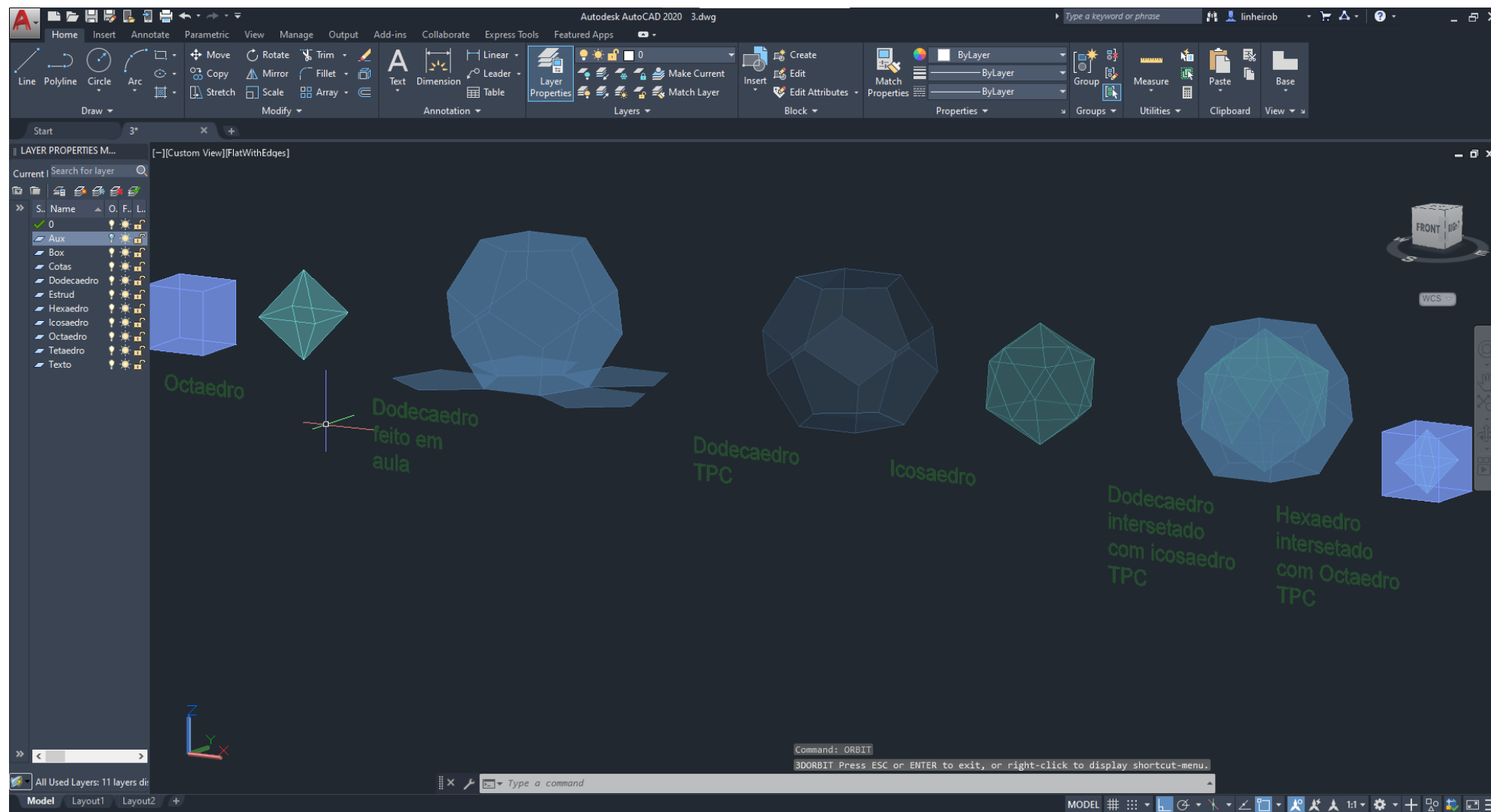
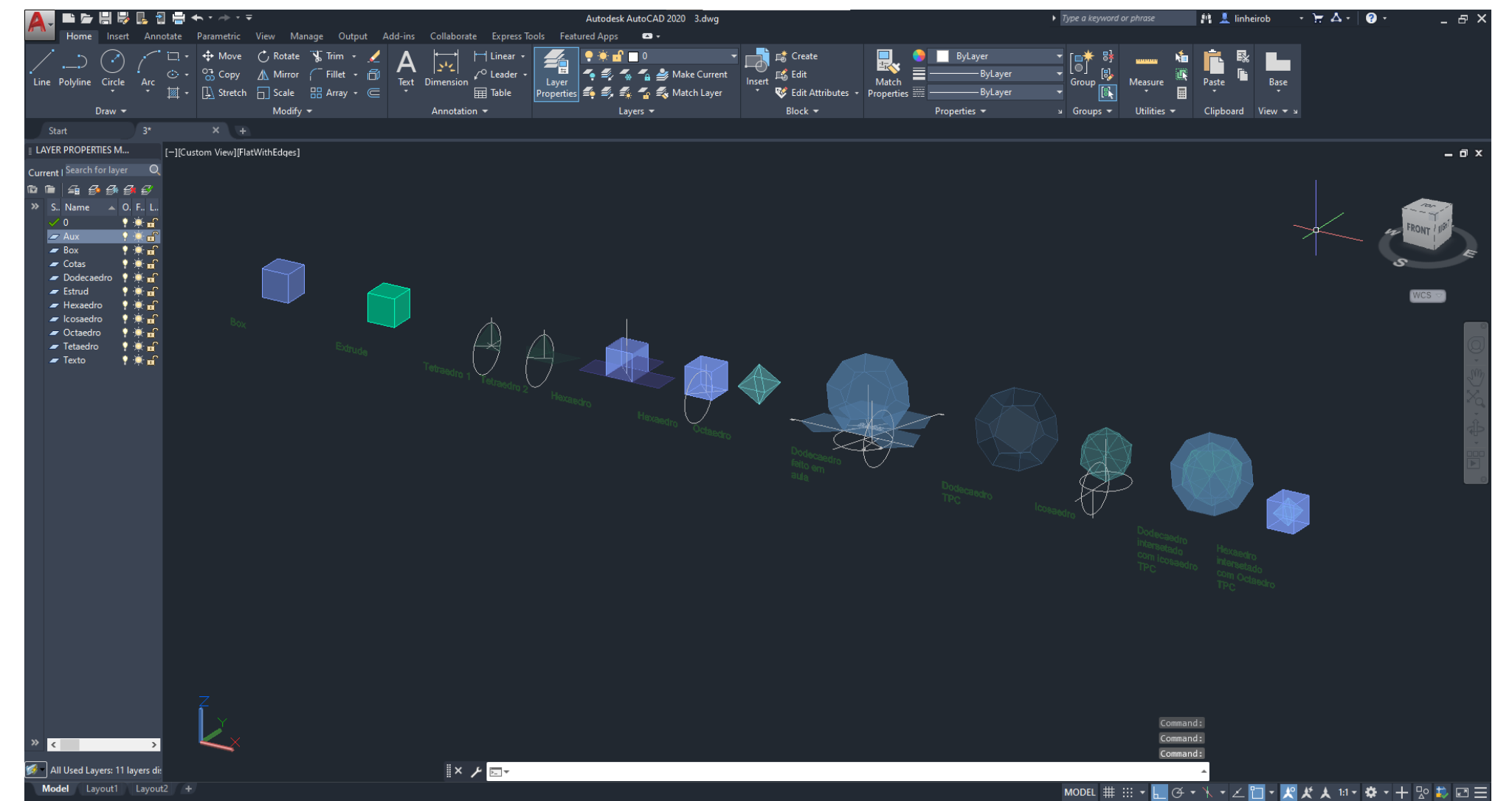
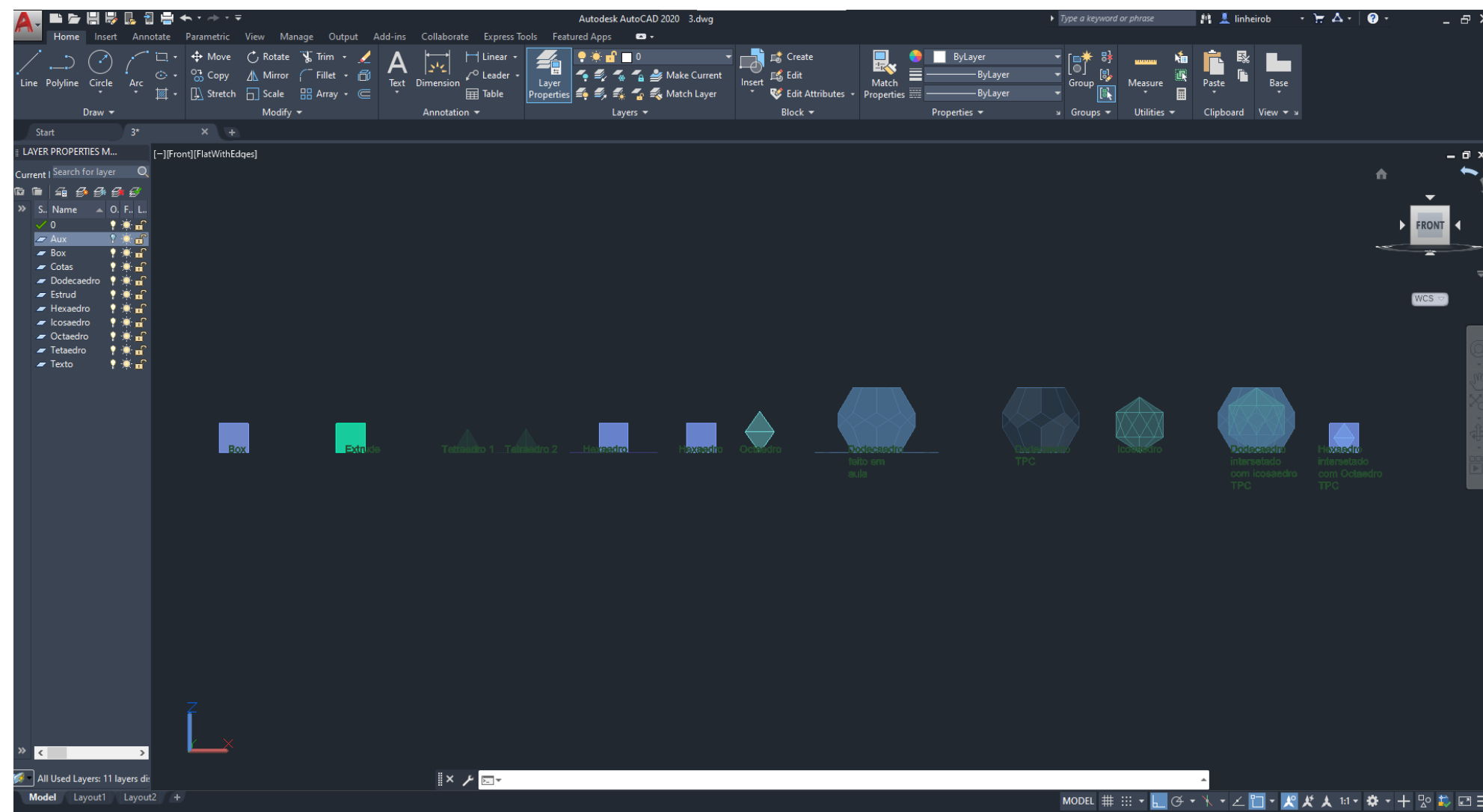

# Exerc. 2 – Figuras tridimensionais – Parte 2

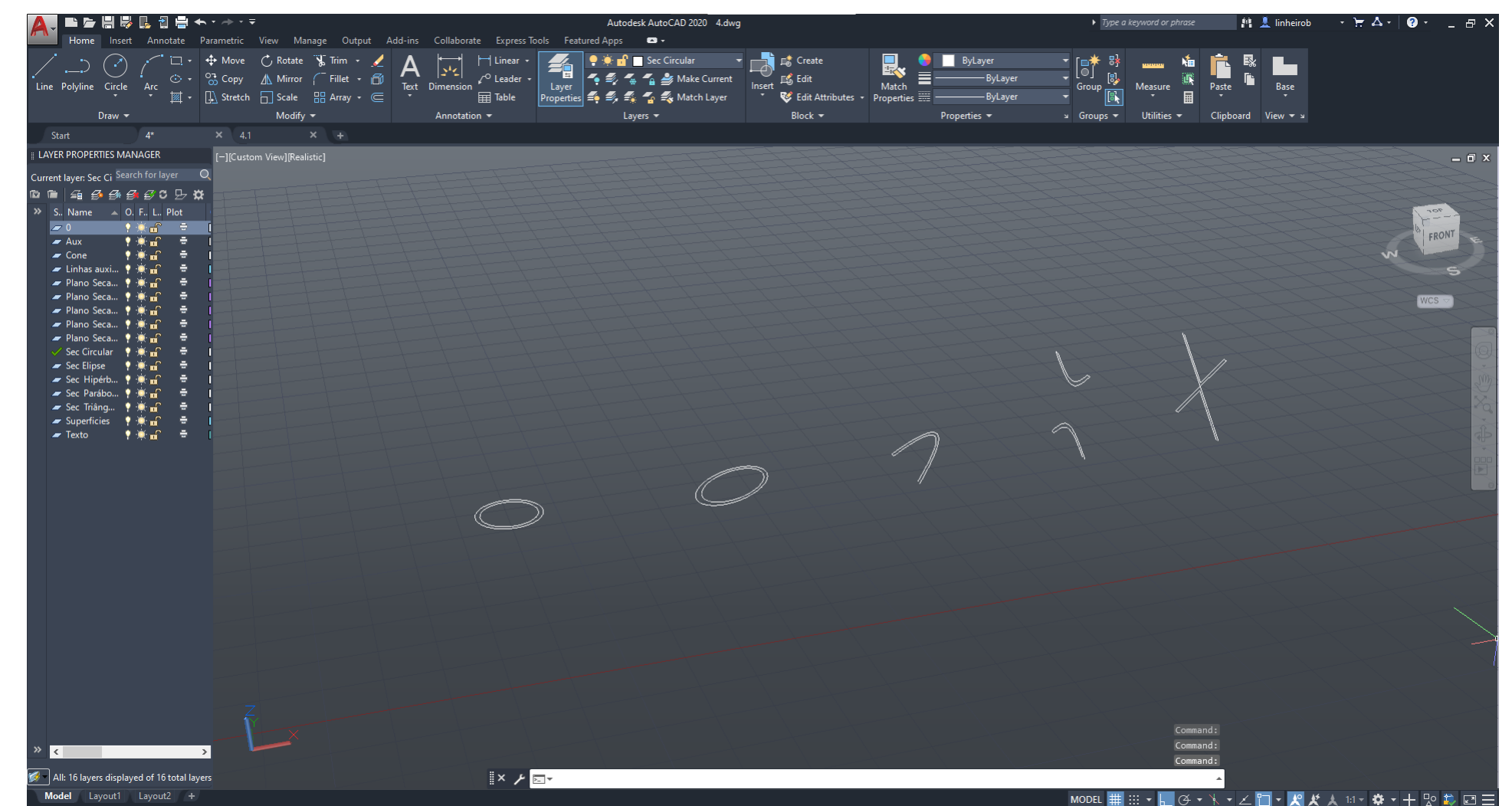
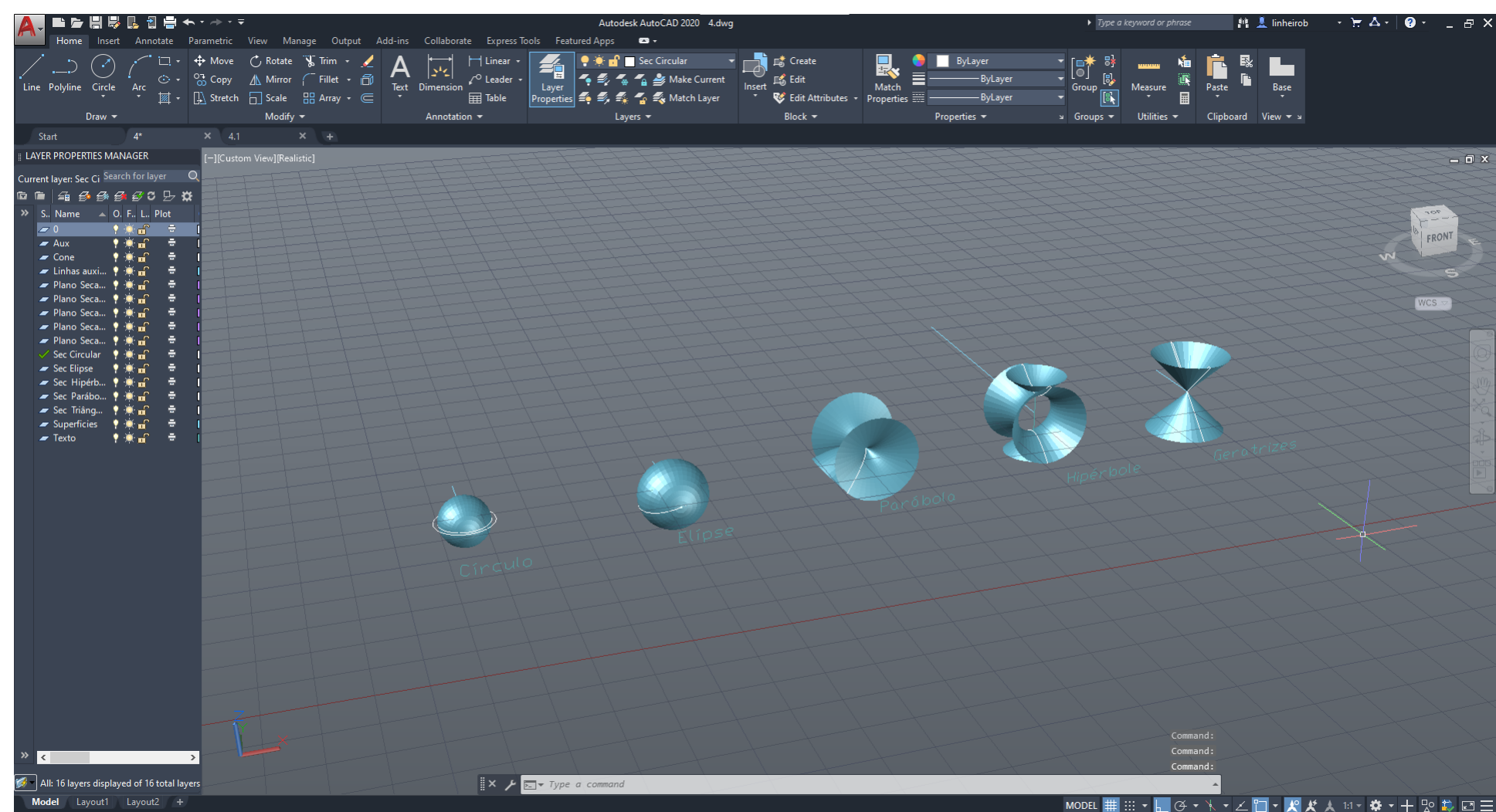
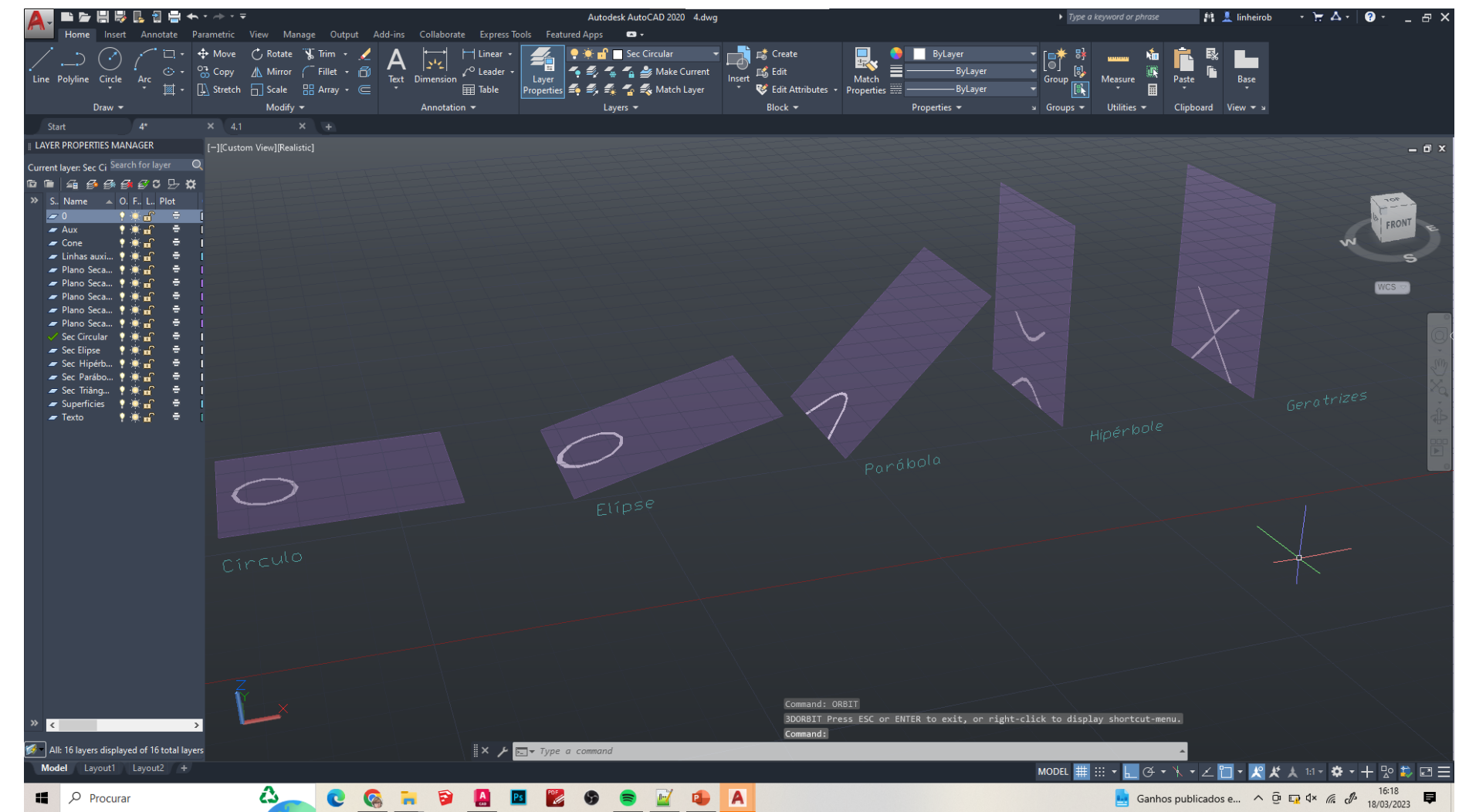
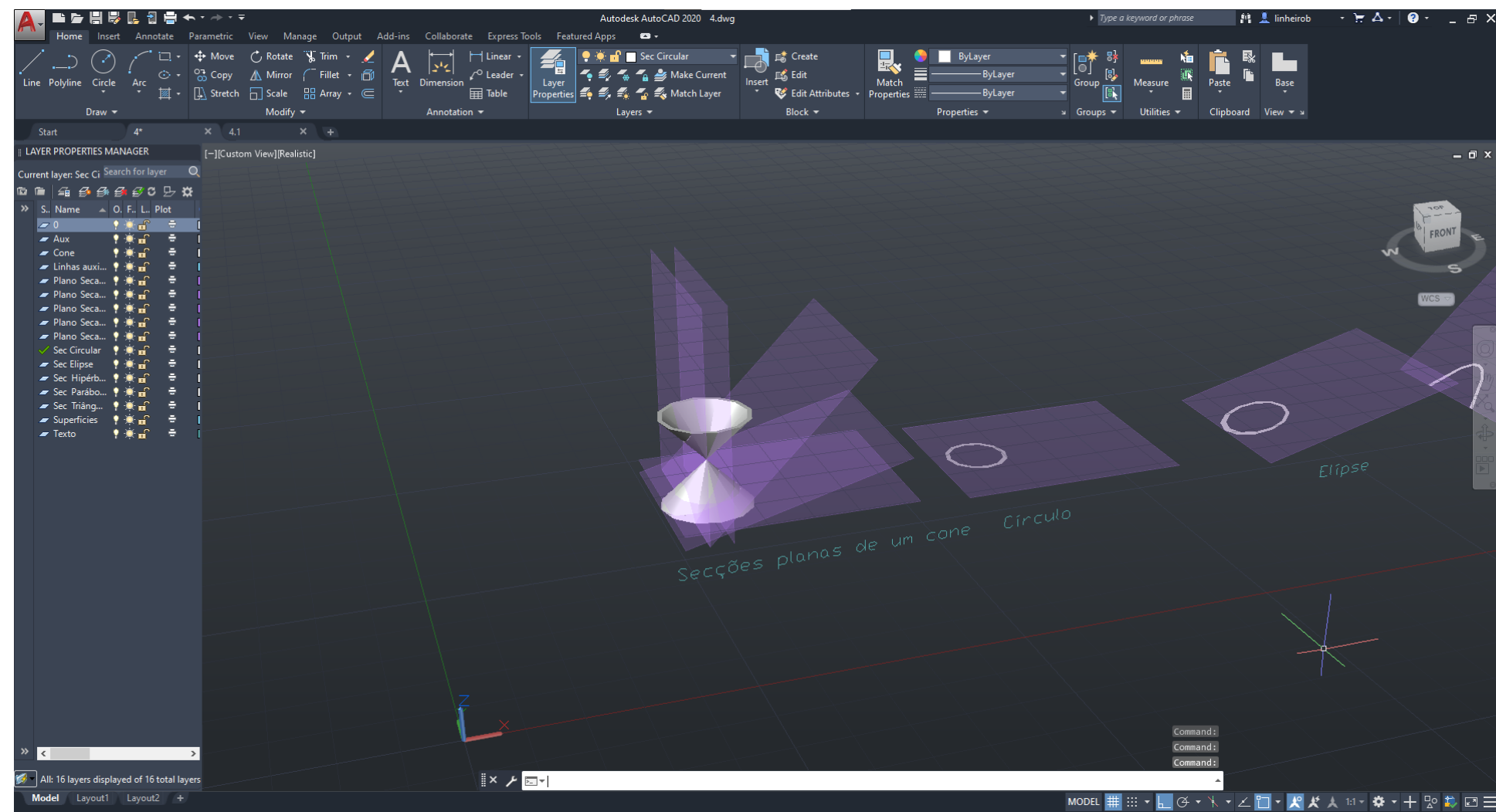

# Exerc. 3 – Secções Planas

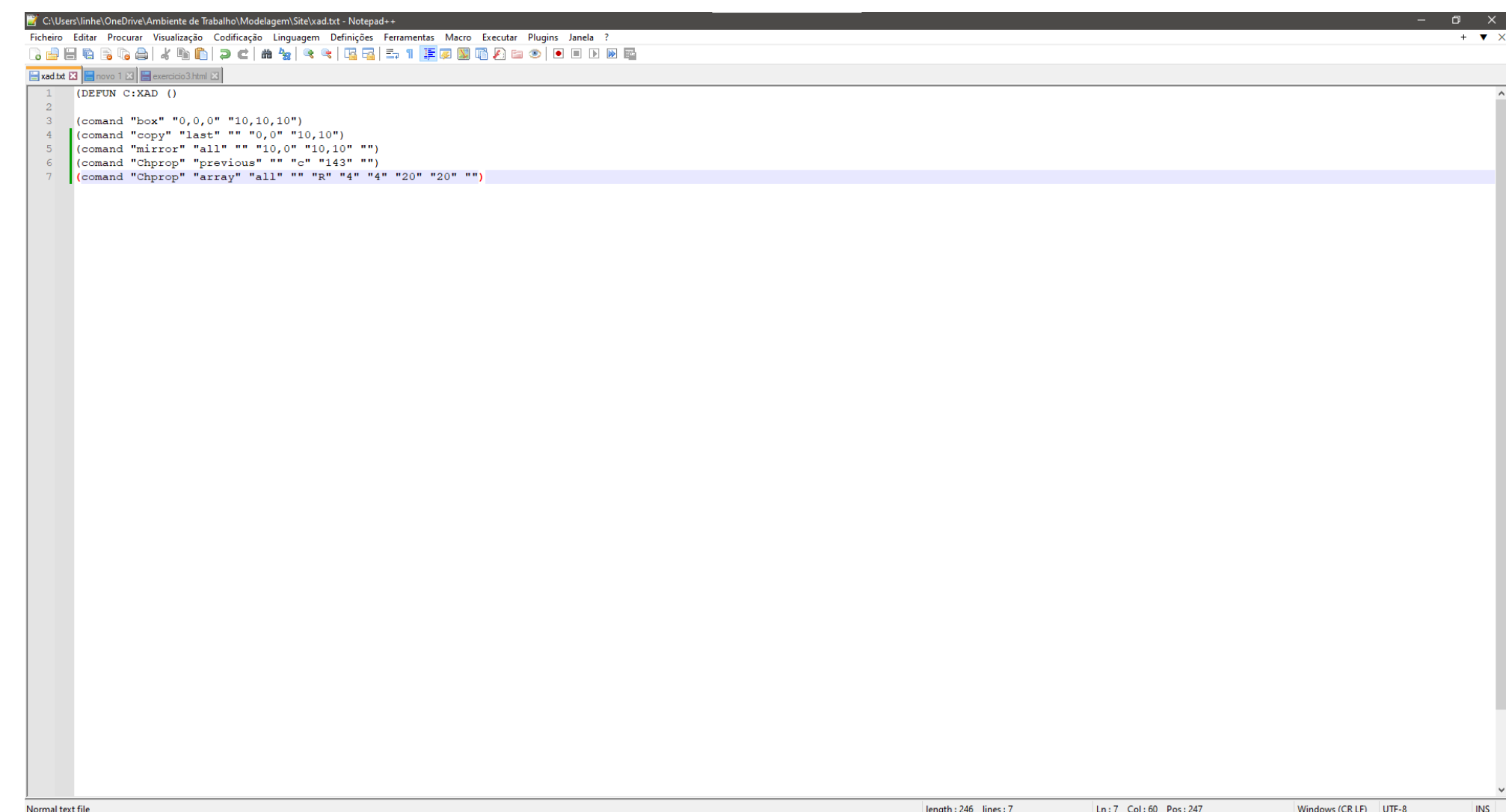
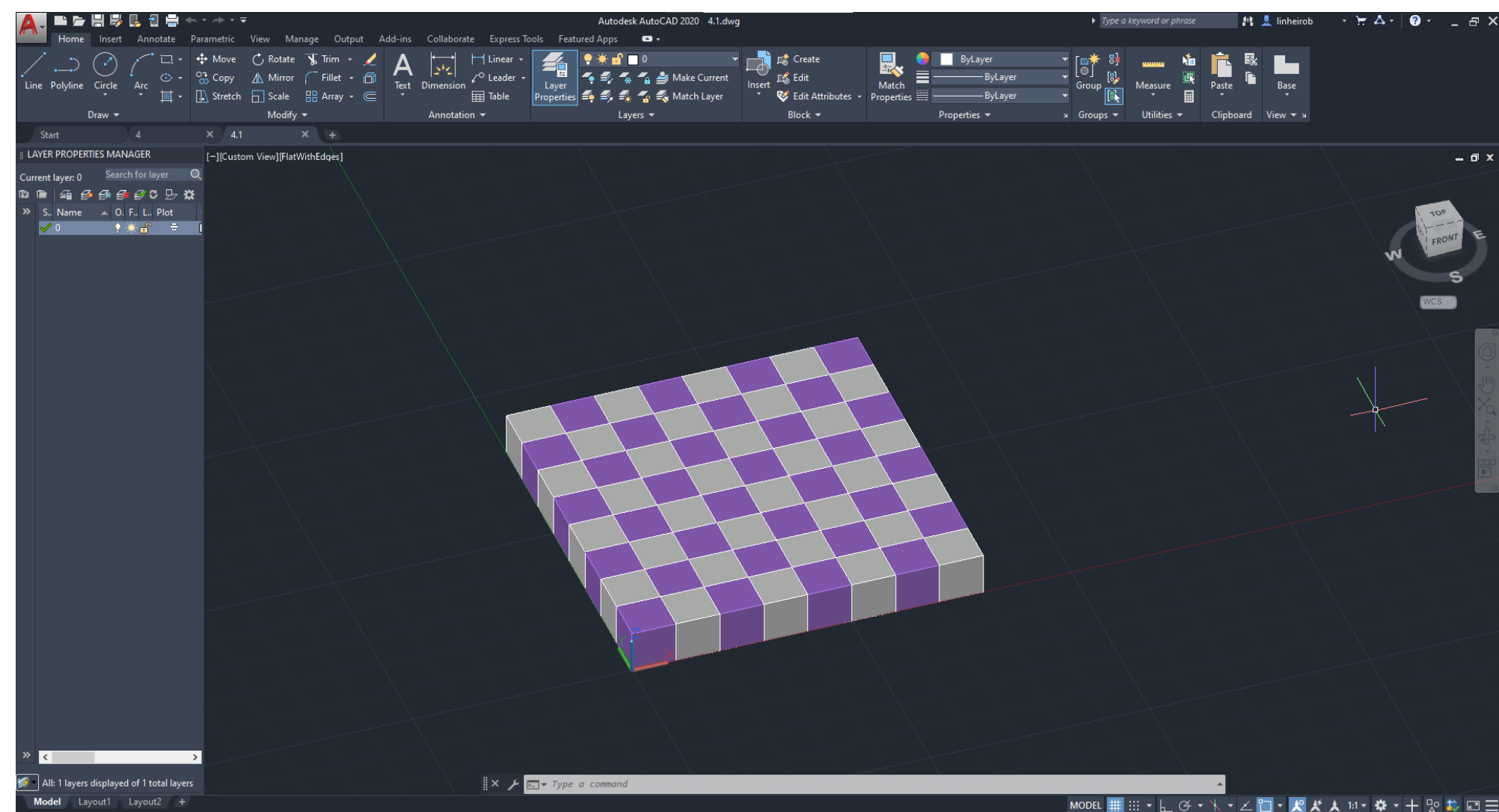

# Exerc. 3.1 – Tabuleiro de Xadrez



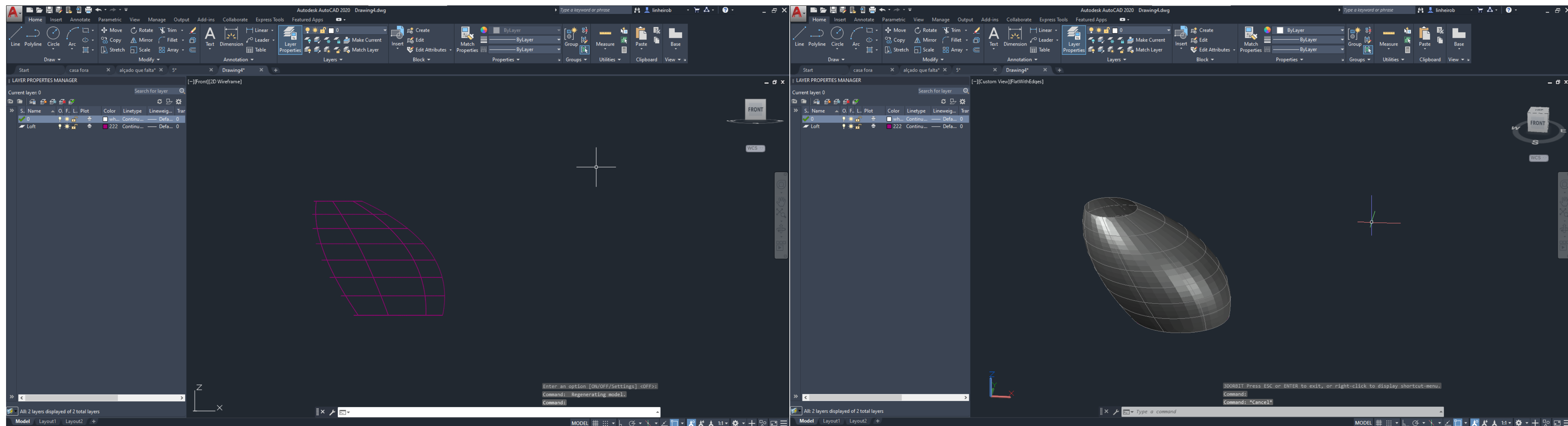

# Exerc. 4 – Loft

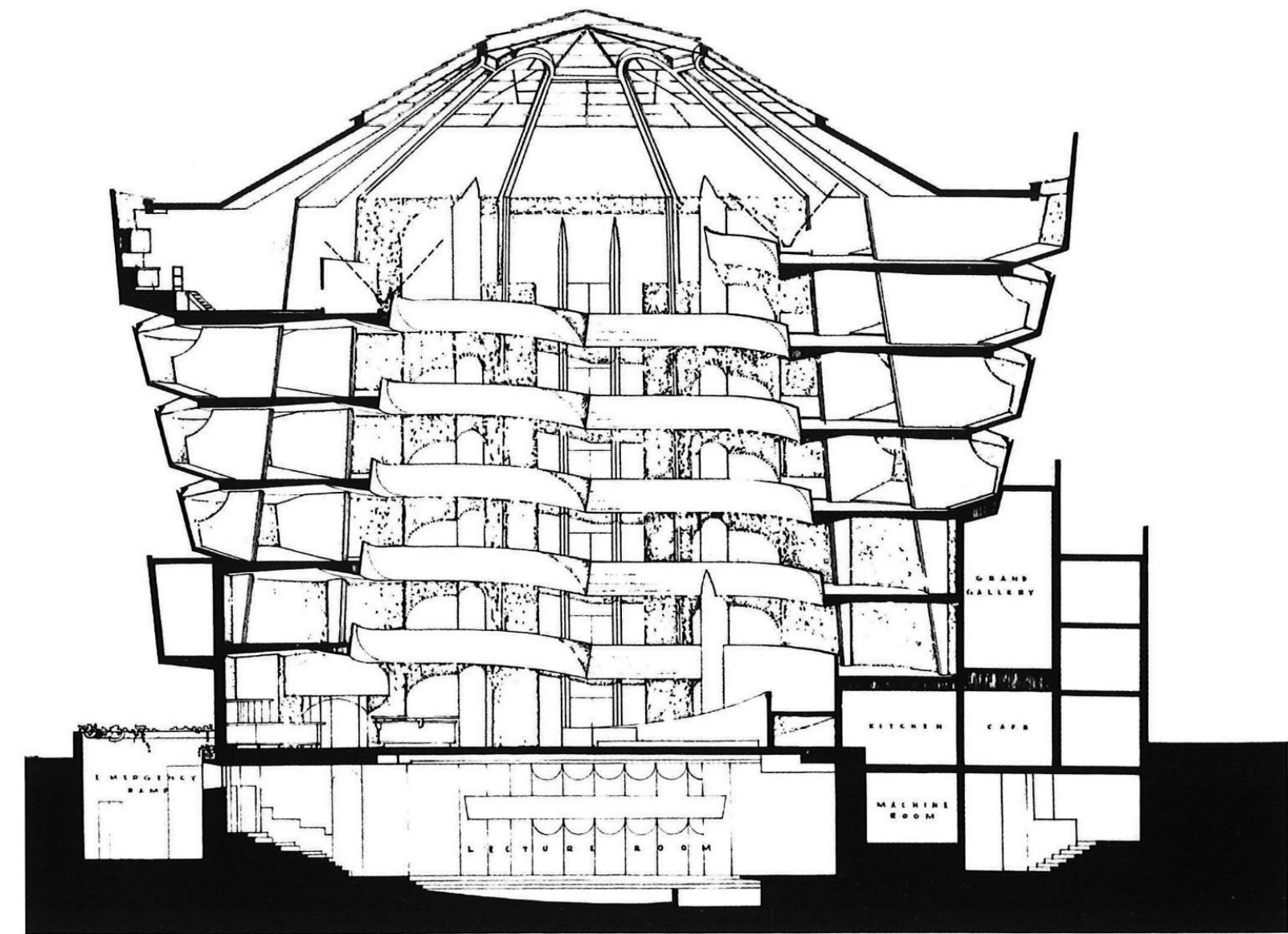
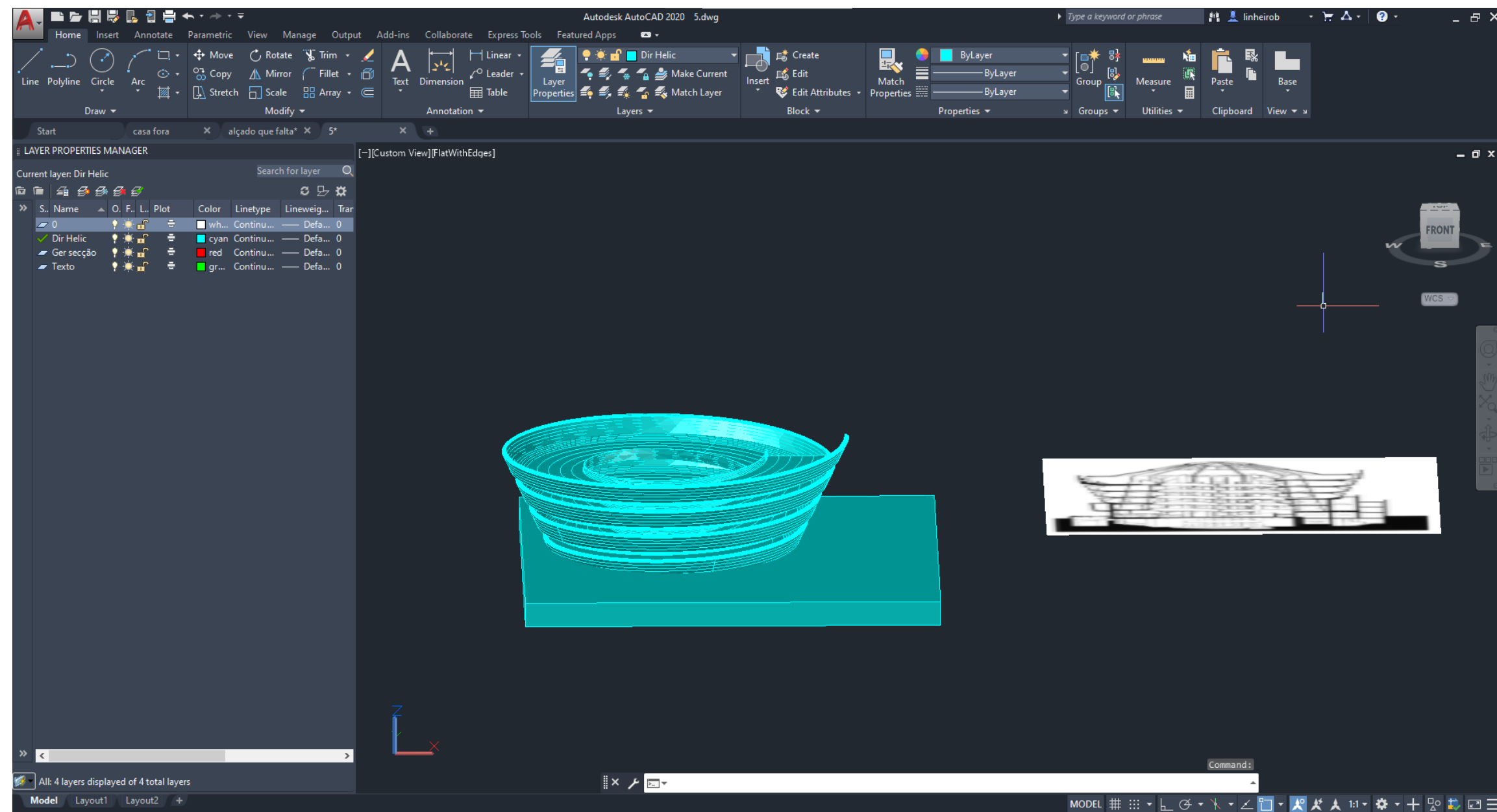

# Exerc. 5 - Museu Solomon R. Guggenheim