

PLANTA
EXISTENTE

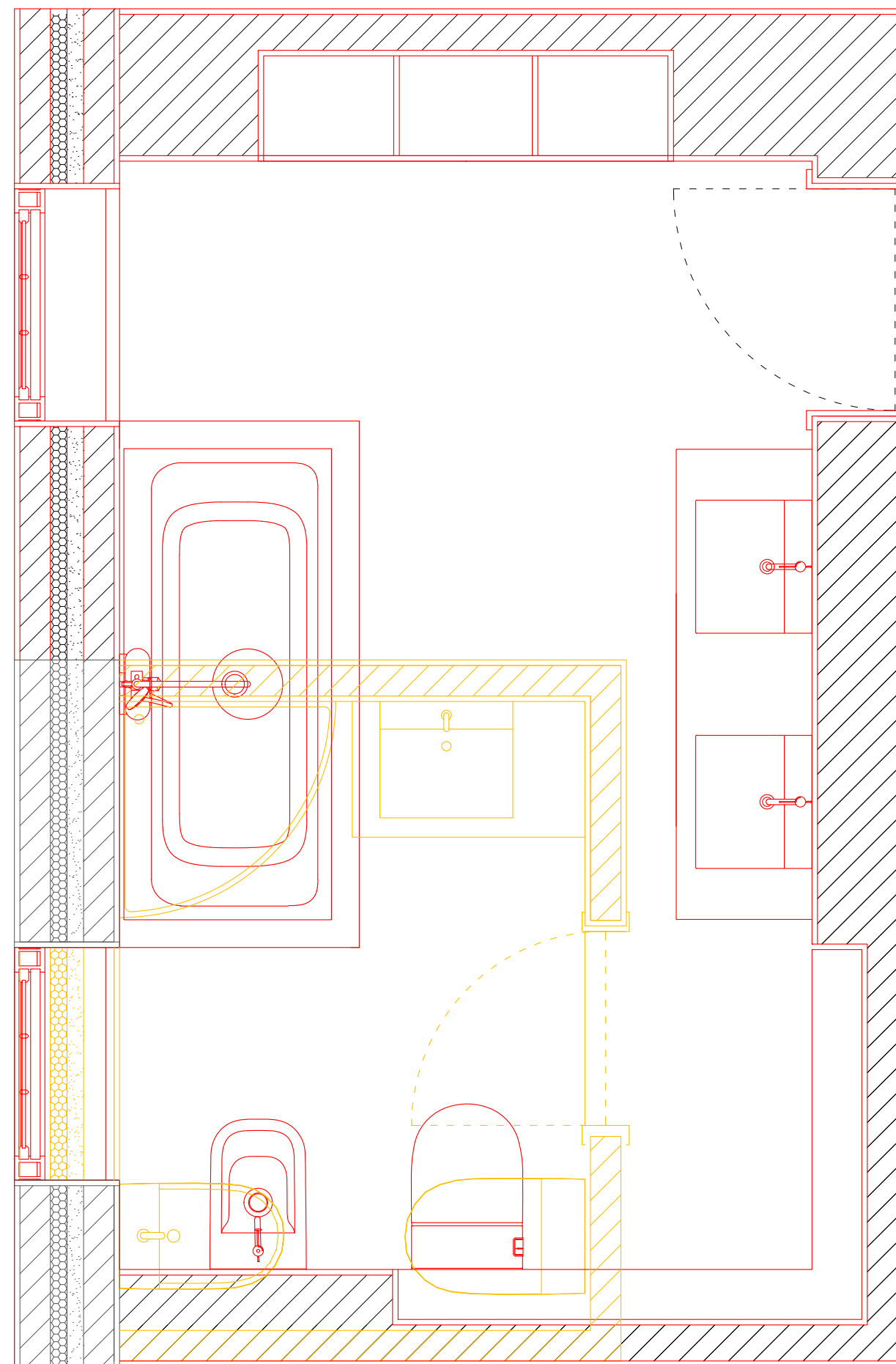

PLANTA AMARELOS E VERMELHOS 1:20

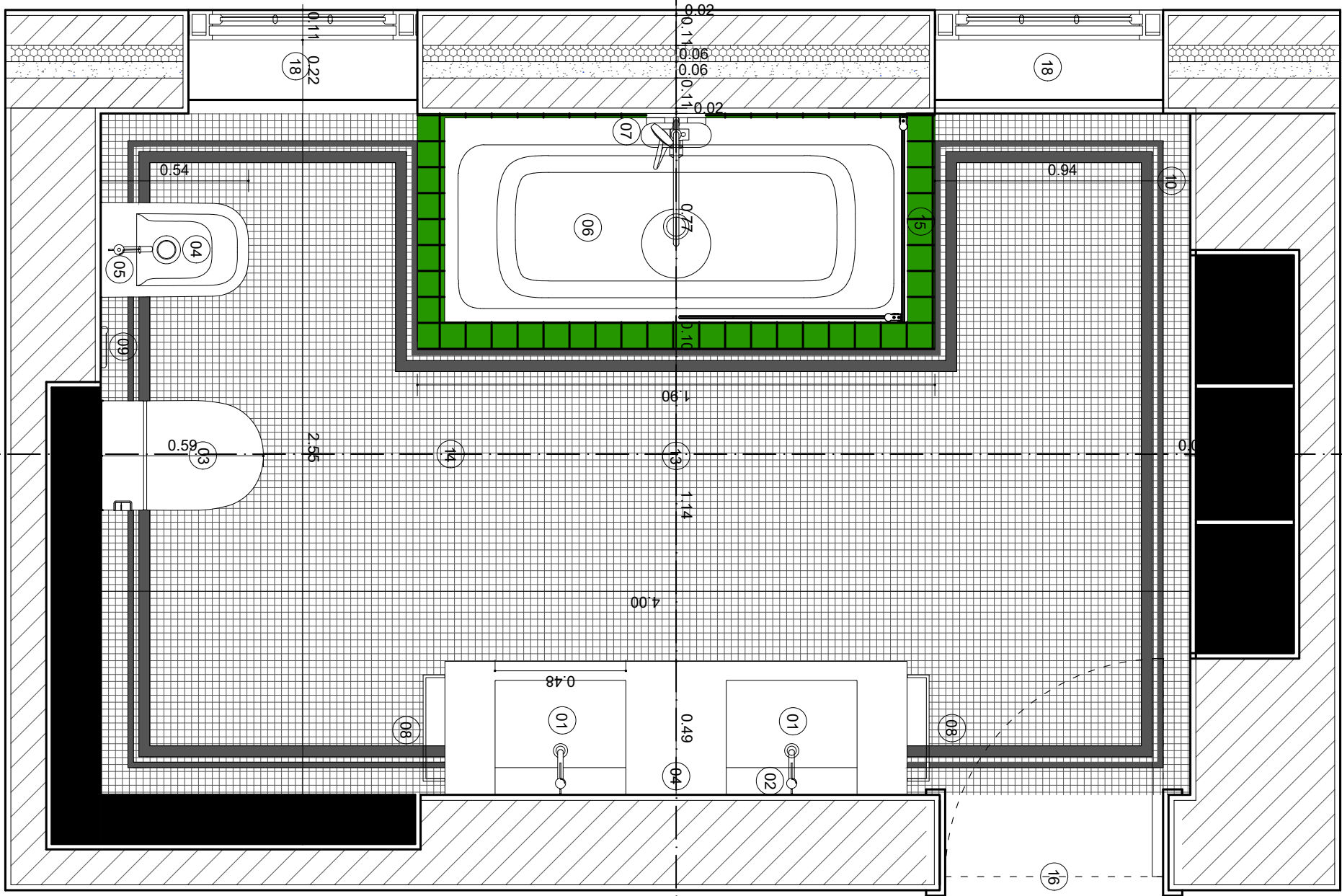
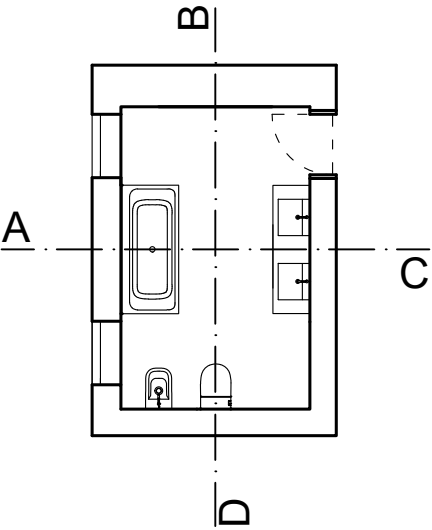

1. Lavatório (ROCA SQUARE - Lavatório mural)
REF:A32752C000
2. Torneira de Lavatório (ROCA- ONA) REF:A5A309EC00
3. Sanita e autoclismo (ROCA-MERIDIAN) REF:A893301000
4. Bidé suspenso (ROCA- GAP) REF: A357476000
Torneira de Bidé (ROCA- ONA) REF:A5A309EC00
5. Base de duche ou Banheira (ROCA-ONA-Banheira em Stonex) REF: A248630000
6. Torneira de Banheira (ROCA-EVEN) REF:A5A9790C00
7. Resguardo de Banheira (ROCA-VICTORIA)
REF:AM19408512
8. Toalheiros
9. Porta Rolos (ROCA- TEMPO) REF:A817033001
10. Cabide (ROCA-TWIN) REF:A816700001
11. Espelho
12. Armário para colocação de elementos necessários à correta utilização do espaço
13. Iluminação (KASHI-Art Colgante) REF: KS2450S
14. Pavimento definido com estereotomia
15. Revestimentos definidos com estereotomia
16. Porta
18. Janela

PLANTA
1:20

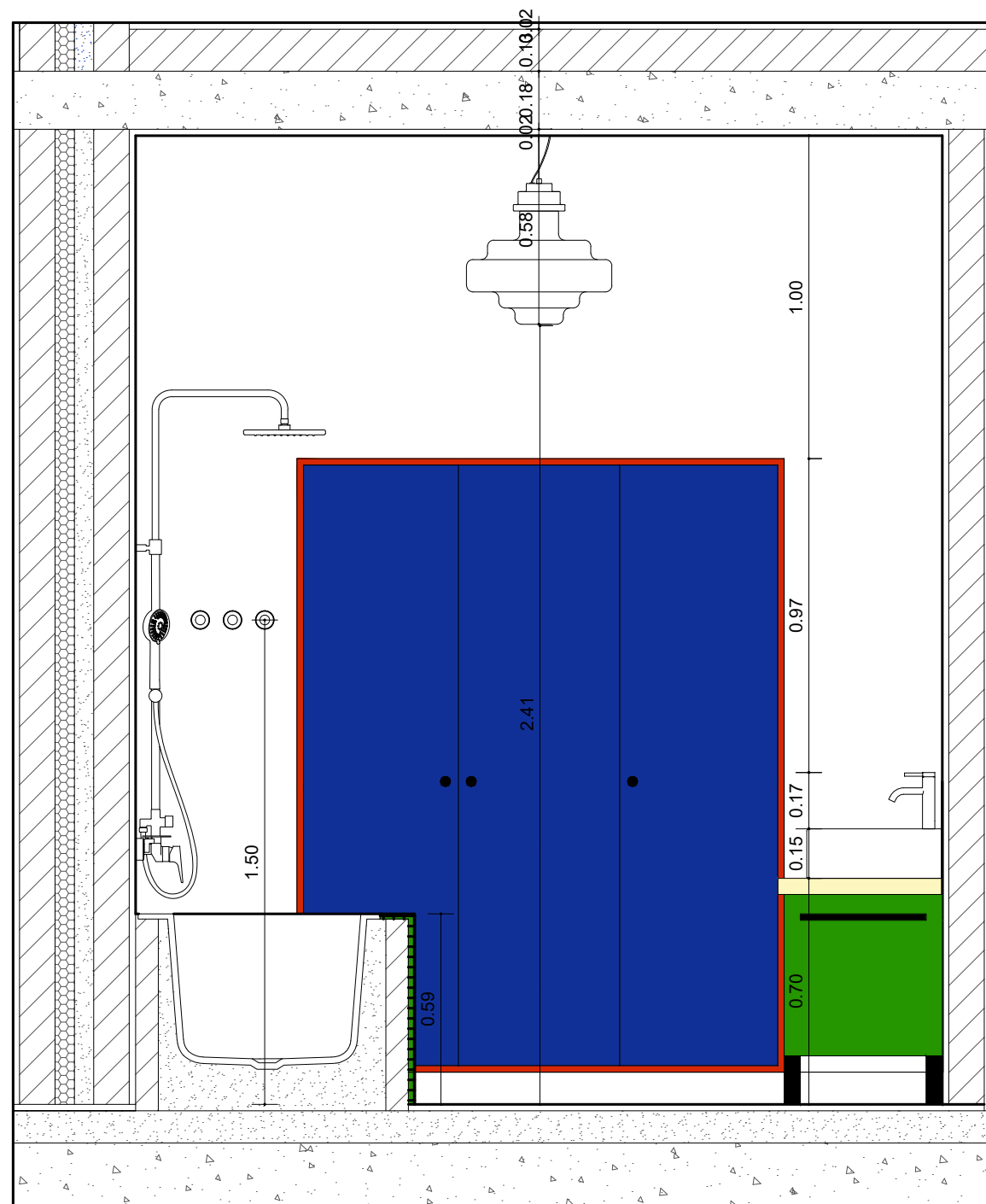

CORTE A
1:20

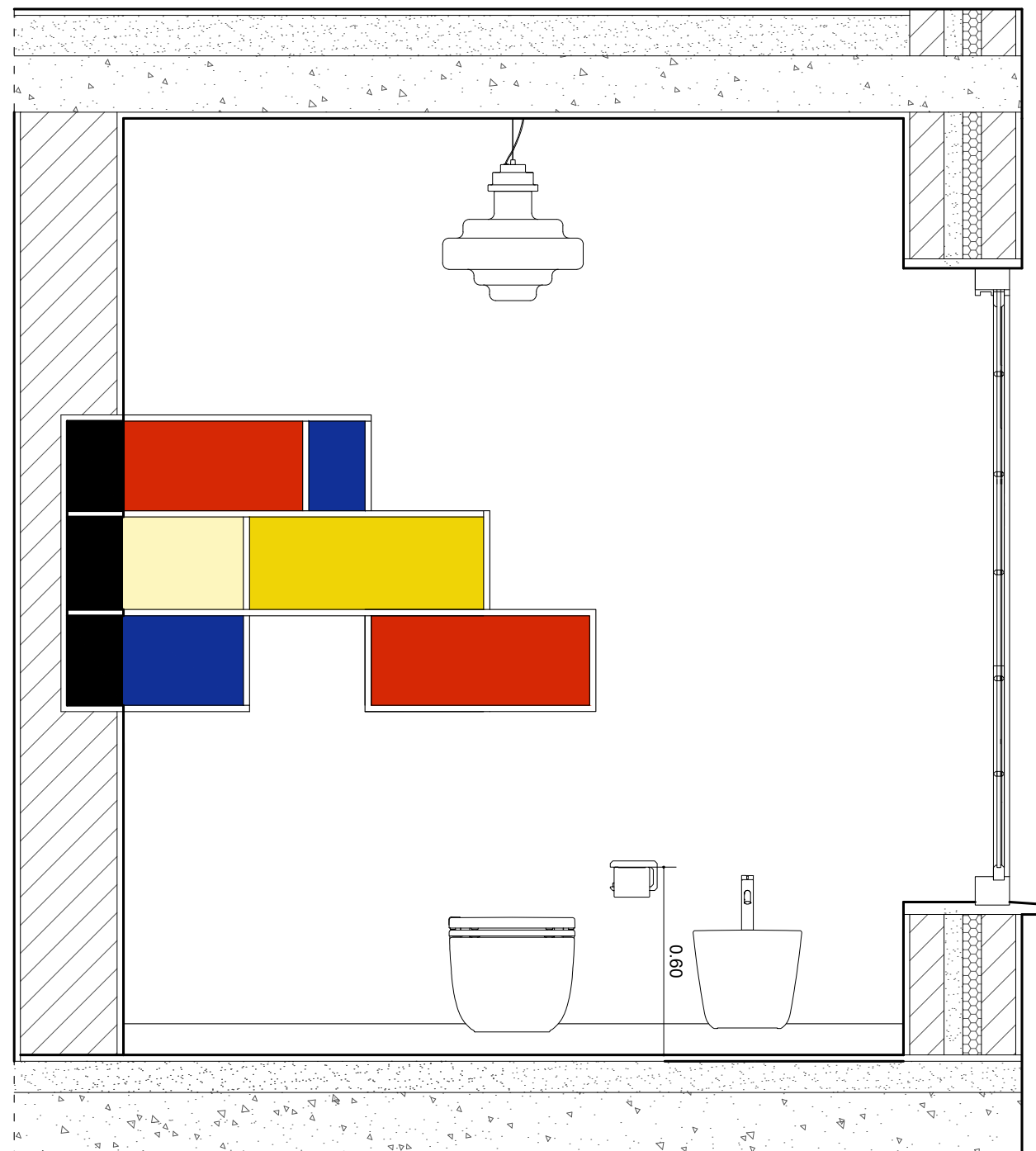

CORTE C
1:20

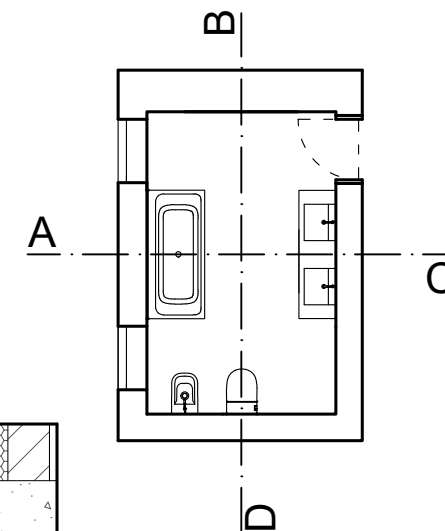

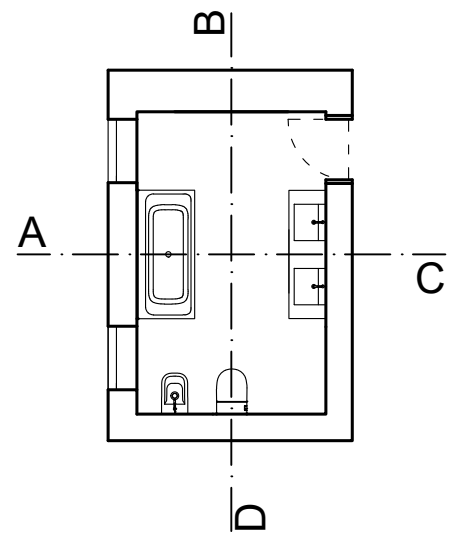
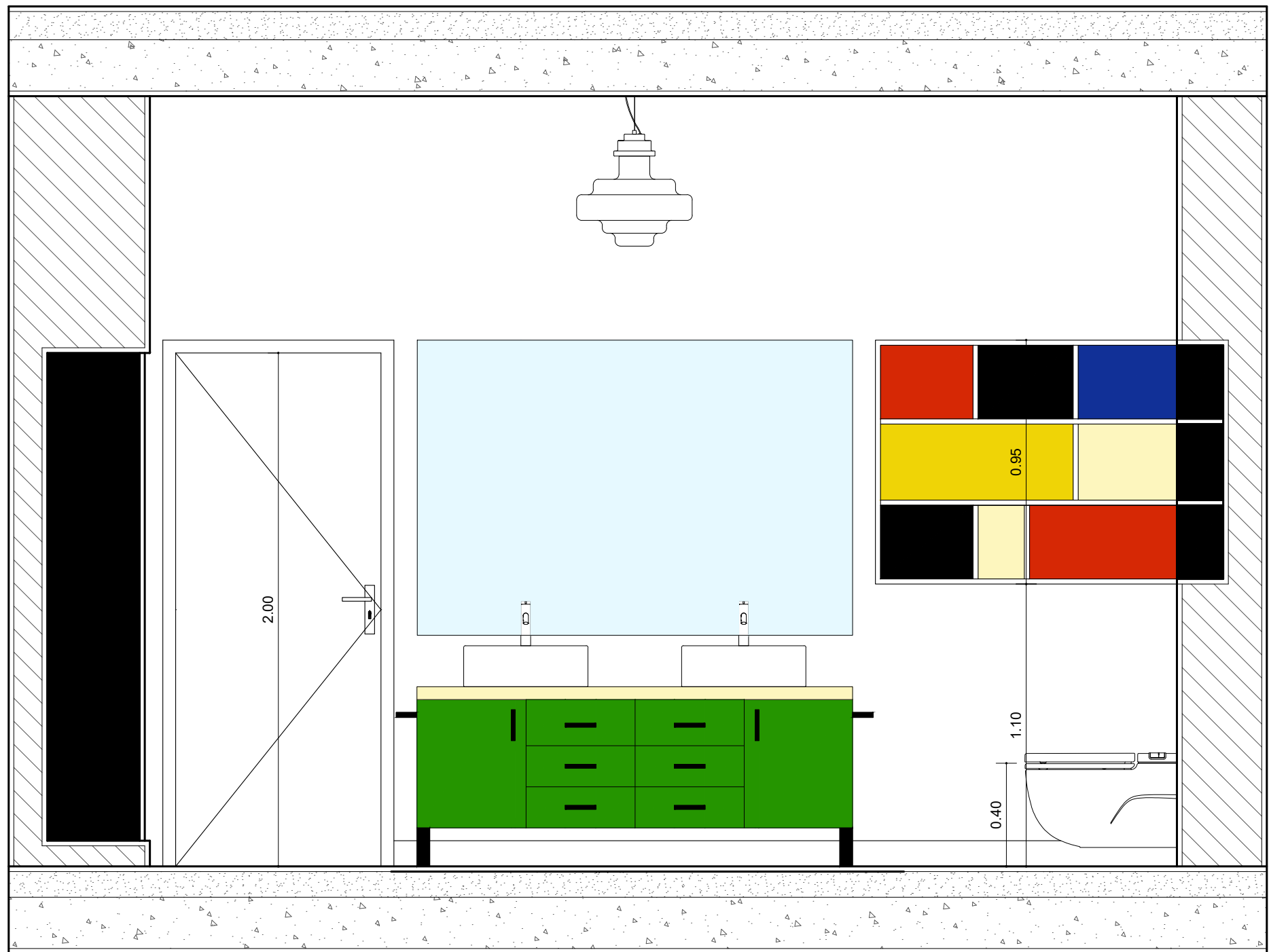

CORTE B
1:20

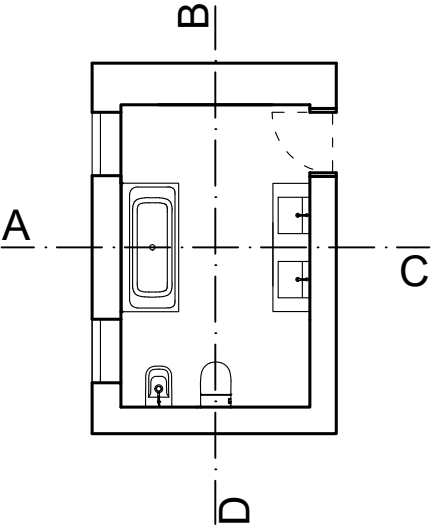
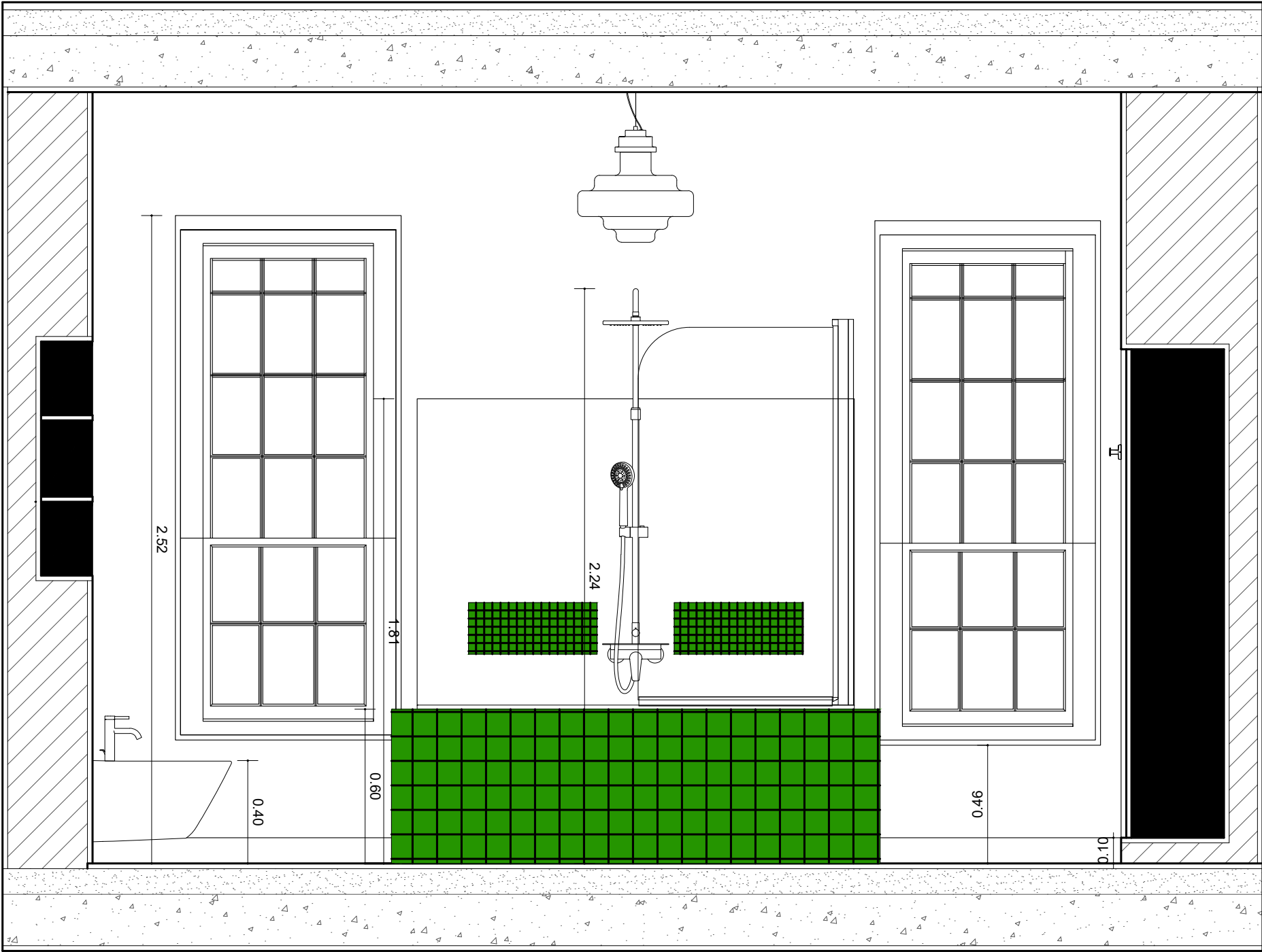

CORTE D 1:20

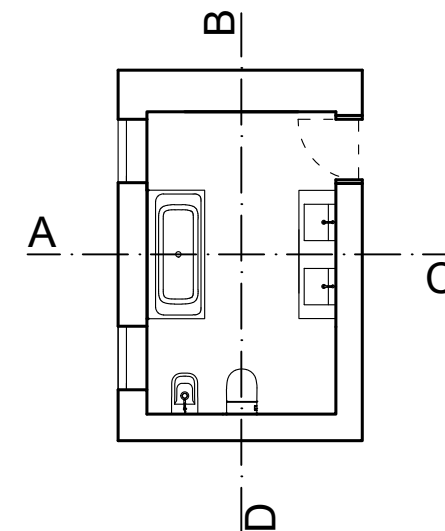
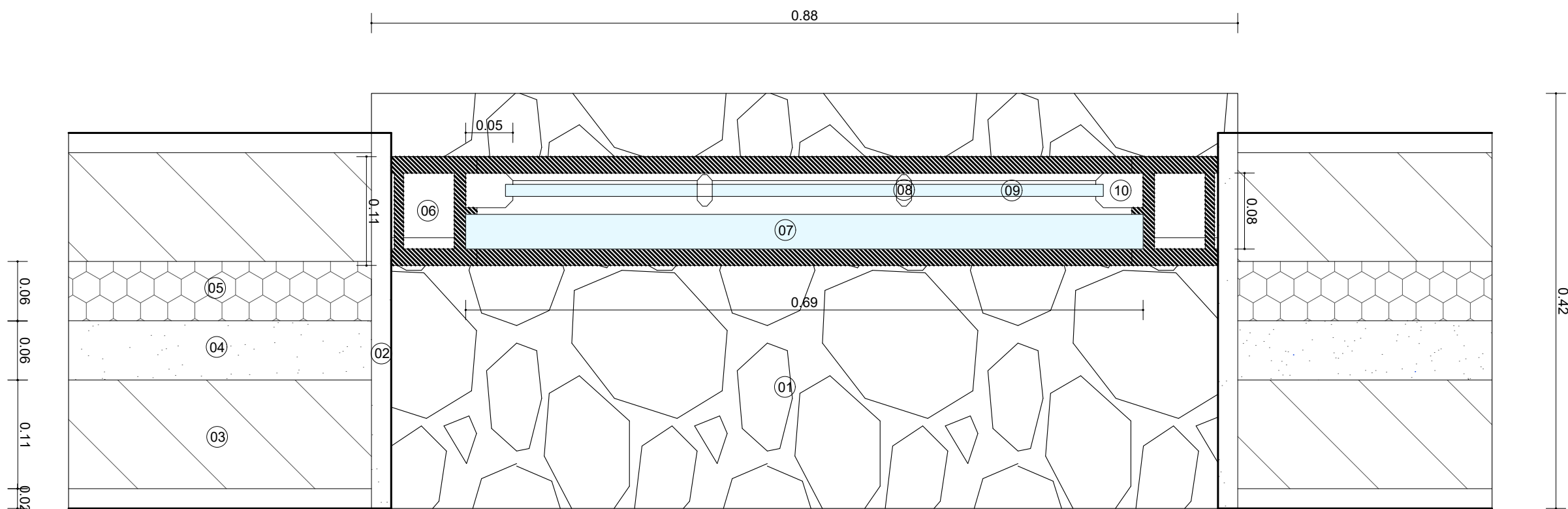

PORMENOR 1:5 CORTE DE JANELA

1. Peito de janela
2. Placa divisoria de betao
3. Tijolo de 11cm
4. Caixa de ar
5. Isolamento térmico
6. Exstructura interior resguardo de janela
7. Primeira placa de vidro
8. Segunda placa de vidro
9. Encaixe peça de vidro
10. Peça de caixilharia